



Flat 2 24 High Street, High Wycombe, HP11 2AG

Asking Price | £230,000

Property Description

A beautifully presented two-bedroom ground floor apartment located in the heart of High Wycombe town centre, just a stone's throw from the train station and close to local amenities.

The apartment offers light and airy accommodation and benefits from a stylish open plan kitchen/lounge area, modern bathroom and a private patio area. Internally the accommodation offers; entrance; open plan kitchen living area with breakfast bar; two double bedrooms with fitted wardrobes; a modern bathroom and private patio area. Further benefits from gas heating. Permit parking is available.

Tenure: Leasehold
Council Tax Band B
EPC Rating **D**

116 years remaining on the lease
Service Charge: £662 per annum
Ground Rent: £100 per annum

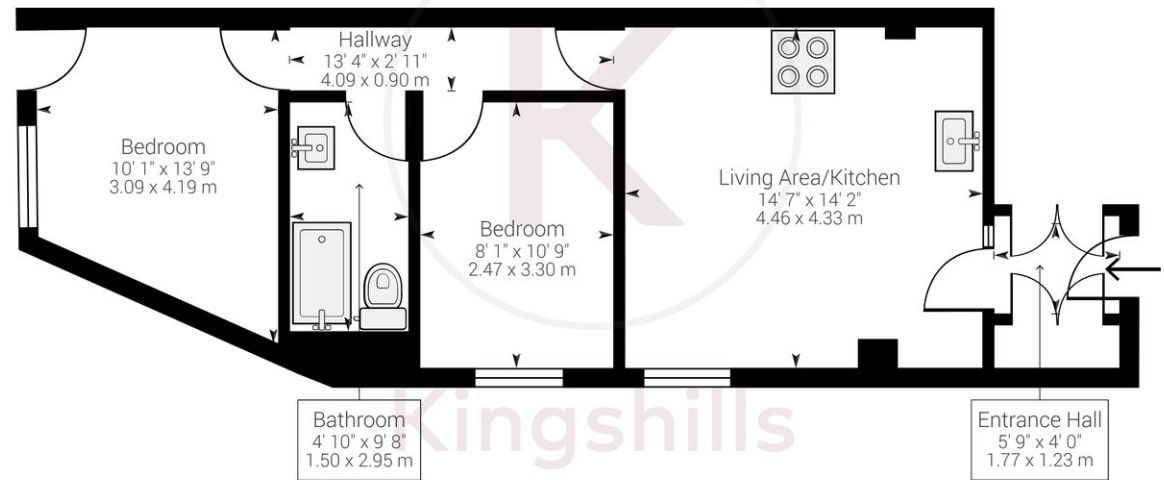

While every attempt has been made to ensure accuracy, all measurements are approximate, not to scale. This floor plan is for illustrative purpose only and should be used as such by any prospective tenant or purchaser.

Powered by Giraffe360

Kingshills Estate Agents
Comet Studios
Amersham
Buckinghamshire
HP7 0PX

01494 939868
hello@kingshills.co.uk
kingshills.co.uk

Agents Note: Whilst every care has been taken to prepare these particulars, they are for guidance purposes only. All measurements are for general guidance purposes only and whilst every care has been taken to ensure accuracy, they should not be relied upon and potential buyers/tenants are advised to recheck the measurements