





£550,000

To View:

Holland & Odam  
30 High Street, Glastonbury, Somerset  
BA6 9DX  
01458 833123  
glastonbury@hollandandodam.co.uk



3



1



2

Energy  
Rating

D

Council Tax Band  
E

**Services**

Oil fired Central Heating

**Local Authority**

Somerset Council  
0300 123 2224

**Tenure**  
Freehold





## Directions

Upon entering the village, proceed past the school on your left, and the turning for Ashcott Road, also on your left. Soon you will see a driveway signposted on your right for Great House Court. Turn in here and follow the driveway down and around to the left, where you will find the entrance into Doran Lodge on your left hand side.



## Location

Meare is a rural village set on the picturesque Somerset Levels, 3 miles to the west of Glastonbury. The village provides a primary school, parish church and farm shop. The historic town of Glastonbury offers a range of shopping facilities, St Dunstan's Community School and Millfield Preparatory School in Edgarley. Street is within 3 miles and provides a further choice of shopping facilities, Strode College and Strode Theatre. The M5 (junction 22) is within 12 miles, Bristol International Airport 22 miles and the nearest main line rail link to London Paddington is at Castle Cary, 19 miles.



## Description

Charming former barn, converted back in the 1970's and updated in more recent times, to provide this most delightful property, situated in the heart of the village.

At the front, there is a wide hallway, almost running the width house, having a cloakroom to the right and access to the utility on the left. A front door leads to an inner hall, where stairs rise to the first floor and a further door opens to the open plan kitchen/dining/breakfast room. The kitchen comprises an extensive range of units having oak work surfaces over and a 'Stoves' LPG/electric range cooker set into the inglenook. Double doors and a window open to the conservatory, which is glazed on three sides, with further doors to the garden. The kitchen provides ample space for a breakfast table, as well as the dining area, where there is a snug recess and a door to the sitting room. Here there is a feature fireplace with inset wood burning stove, exposed wooden beams and two sets of doors out onto the patio and garden. Finally on the ground floor, accessed from the kitchen, is the utility room, complete with space for a washing machine, tumble drier and fridge/freezer. There is also a 'belfast' sink and fitted storage cupboards, with a door at one end to the garden.

On the first floor, there are three double bedrooms and a family bathroom, leading from the landing. The master bedroom enjoys a dual aspect, as does bedroom three, with windows to the front and rear, with the master bed having built in wardrobes and shutters to both sets of windows. Bedroom two, enjoys a rear facing aspect looking out over the garden. Finally, the family bathroom, having an oak floor, is fitted with separate shower enclosure, bath, WC and wash hand basin.



The property is approached at the front, over brick paved driveway with parking for several vehicles up to the front of the property. On the left there is a wooden carport, with a secure store at the rear, and adjoining, there are two further secure wooden stores.

The rear garden is enclosed and is well established with a fine array of mature shrubs and plants, including a banana plant. Here there is also a lawn and a patio extending from the rear and the conservatory. The well sheltered garden enjoys a secluded southerly aspect, ideal for 'al-fresco' dining.

- Beautifully presented former barn conversion, situated in a secluded location just off the centre of the village
- On the ground floor, there is a wide entrance hall, kitchen/breakfast/dining room, snug, sitting room, conservatory and utility
- Three good bedrooms are situated on the first floor, along with the family bathroom
- At the front, the property is set back behind a large brick paved driveway, carport and stores
- The rear garden is enclosed, affording a variety of mature shrubs and plants and a great degree of seclusion
- Also enjoying a lovely southerly aspect and patio areas, ideal for dining out doors in the summer months



## GROUND FLOOR

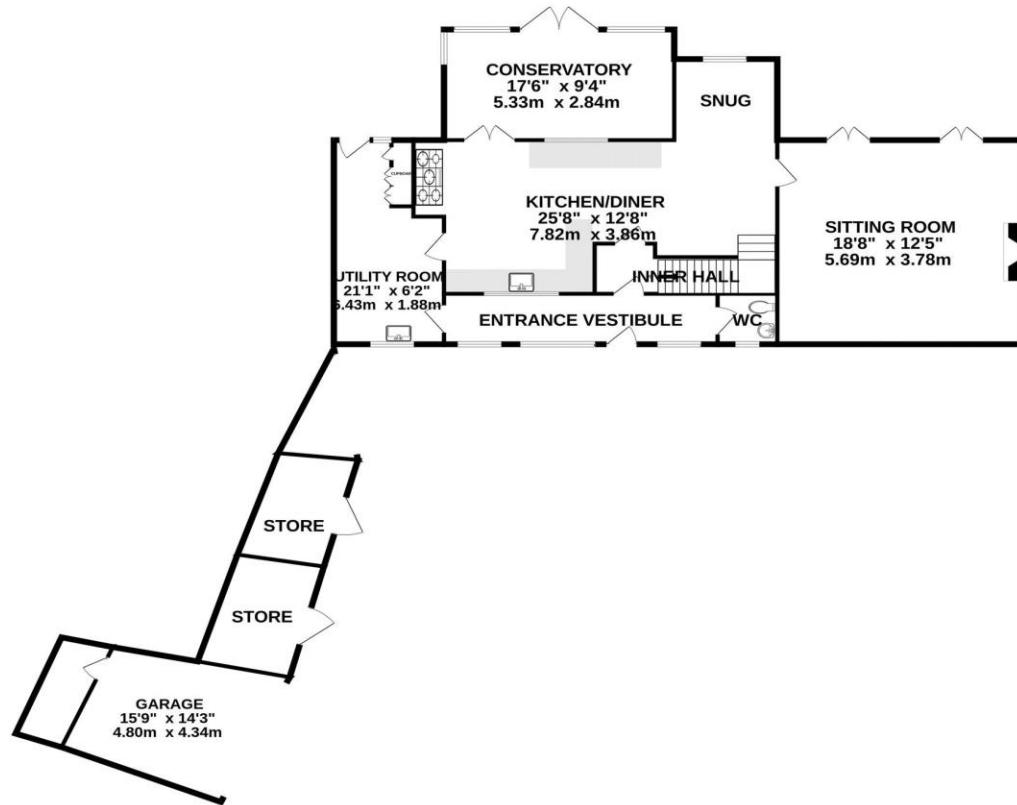

## 1ST FLOOR



DORAN LODGE, GREAT HOUSE COURT, ST MARYS ROAD, MEARE, BA6 9SR

Whilst every attempt has been made to ensure the accuracy of the floorplan contained here, measurements of doors, windows, rooms and any other items are approximate and no responsibility is taken for any error, omission or mis-statement. This plan is for illustrative purposes only and should be used as such by any prospective purchaser. The services, systems and appliances shown have not been tested and no guarantee as to their operability or efficiency can be given.  
Made with Metropix ©2023

**RESIDENTIAL LETTINGS** : Holland & Odam offer a comprehensive residential lettings service. Whether you are a landlord or a tenant, please contact any of our offices to discuss your requirements.

**FINANCIAL SERVICES** : Would you like to have the opinion of a fully Independent Financial Adviser who has access to the entire mortgage market place and could help you consider all aspects of financing your proposed purchase? If so, please ring us on 01458 833123 and we can arrange a free consultation for you at a time and a place to suit you with Woodward Insurance & Mortgage Insurance Services.\*

**CONSUMER PROTECTION FROM UNFAIR TRADING REGULATIONS 2008** : The Agent has not tested any apparatus, equipment, fixtures and fittings or services and so cannot verify that they are in working order or fit for the purpose. A Buyer is advised to obtain verification from their Solicitor or Surveyor. References to the Tenure of a Property are based on information supplied by the Seller. The Agent has not had sight of the title documents. A Buyer is advised to obtain verification from their Solicitor. Items shown in photographs are not included unless specifically mentioned within the sales particulars. They may however be available by separate negotiation. Buyers must check the availability of any property and make an appointment to view before embarking on any journey to see a property.

**DATA PROTECTION** : Personal information provided by customers wishing to receive information and/or services from the estate agent and the Property Sharing Experts (of which it is a member) for the purpose of providing services associated with the business of an estate agent but specifically excluding mailing or promotions by a third party. If you do not wish your personal information to be used for any of these purposes, please notify us.

\*YOUR HOME MAY BE REPOSSESSED IF YOU DO NOT KEEP UP REPAYMENTS ON YOUR MORTGAGE OR ANY OTHER DEBT SECURED ON IT. WRITTEN QUOTATIONS ARE AVAILABLE ON REQUEST.

