



Property Description

A modern and well-presented two-bedroom apartment located in the highly sought-after village of Penn, which offers beautiful woodland areas and local amenities. Internally the property offers spacious accommodation and benefits from two double bedrooms. The accommodation comprises; security communal entrance; entrance hall; open plan kitchen/living area; two bedrooms and a recently fitted modern bathroom. The property further benefits from well-kept communal gardens, gas central heating and residents parking. Available on an unfurnished basis from 19th October 2023.

COUNCIL TAX C

EPC RATING C

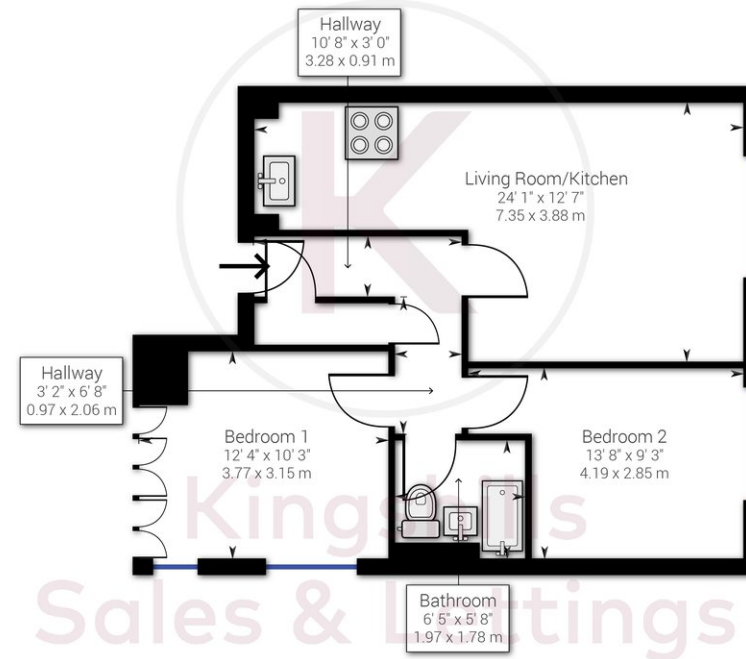

While every attempt has been made to ensure accuracy, all measurements are approximate, not to scale. This floor plan is for illustrative purpose only and should be used as such by any prospective tenant or purchaser.

Powered by Giraffe360

Kingshills Estate Agents
Comet Studios
Amersham
Buckinghamshire
HP7 0PX

01494 939868
hello@kingshills.co.uk
kingshills.co.uk

Agents Note: Whilst every care has been taken to prepare these particulars, they are for guidance purposes only. All measurements are for general guidance purposes only and whilst every care has been taken to ensure accuracy, they should not be relied upon and potential buyers/tenants are advised to recheck the measurements