



1 Coppice Farm Road, Penn, High Wycombe, Buckinghamshire, HP10 8AN

Asking Price | £650,000

Property Features

- Semi Detached Family Home
- Non Estate Location
- 3/4 Bedrooms
- 2/3 Reception Rooms
- Open Plan Kitchen/Diner
- 2 Bathrooms
- Stunning 100ft+ Rear Gardens
- Catchment of Highly Regarded Schools
- Off Road Parking o the Front
- EPC - TBC

Full Description

Welcome to Coppice Farm Road, a thoughtfully extended 3/4 bedroom semi-detached home nestled in the charming village of Tylers Green. This delightful property boasts a garden that stretches over 100ft in length, providing a serene and private outdoor oasis.

Upon entering, you are greeted an entrance porch that leads into a bay-windowed living room with its own open fireplace. The heart of the home is the open-plan kitchen/diner, seamlessly connected to a spacious family room. This family room features a stunning vaulted ceiling and doors that open onto the expansive and secluded garden.

The ground floor also includes a versatile 4th bedroom/ family room, ideal for guests or as a flexible living space. Completing the downstairs is a modern bathroom and a convenient utility room.

Upstairs, you will find three well-proportioned bedrooms, each designed with comfort in mind, and a contemporary family bathroom.

Outside, the front of the property offers off-road parking. The rear garden is a true highlight, featuring a large patio area perfect for outdoor dining and entertaining, leading to an extensive lawn area. Enclosed by mature hedging, the garden provides a high degree of privacy and tranquility.

1 Coppice Farm Road is within the catchment area of highly regarded schools, making it an excellent choice for families. The property is also conveniently located near the train stations of High Wycombe, Beaconsfield, and Amersham, offering easy access to London and beyond.





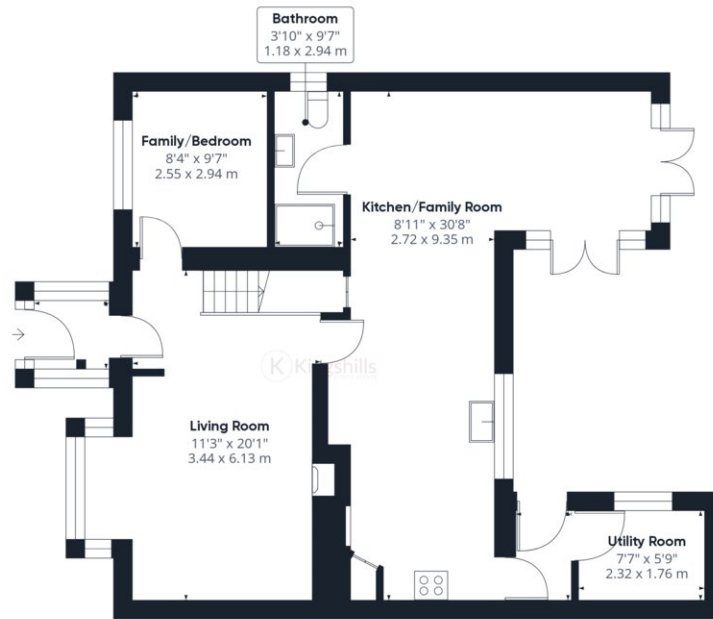

Ground Floor

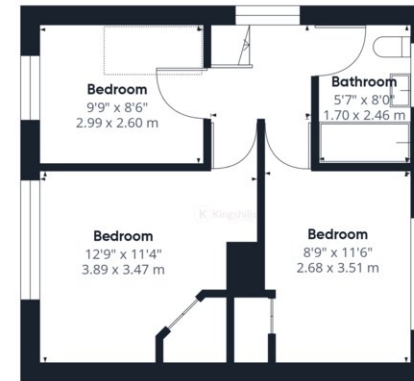

Floor 1

Approximate total area⁽¹⁾
1242.35 ft²
115.42 m²

(1) Excluding balconies and terraces

While every attempt has been made to ensure accuracy, all measurements are approximate, not to scale. This floor plan is for illustrative purposes only.

GIRAFFE360