



3 SWANSFIELD PARK
ROAD
ALNWICK

AYRE
PROPERTY
SERVICES

01669 621312
ayrepropertyservices.co.uk

£195,000

GUIDE
PRICE

An attractive mid terraced stone-built house within walking distance of the town centre and the Alnwick Garden. The accommodation is arranged over two floors and comprises Entrance Hall, Sitting Room, Kitchen/Dining Room, Utility 2 Bedrooms and modern Bathroom. There is a small stone yard to the rear of the property and small garden to the front of the property. The property retains much character and features including fireplaces, stripped floors and deep skirtings.

Alnwick

Awareness of the Alnwick District has grown significantly in the last few years. The Duchess of Northumberland's Gardens and the mysterious village of Lilidorei at Alnwick Castle are now internationally known and have provoked much interest in the town. Alnwick is well served by the A1 and the east coast mainline railway (providing links to Edinburgh, Newcastle and London) and is within easy reach of the stunning Northumberland coast, the Cheviot Hills and the Scottish Borders.



Services

Mains electricity, gas, drainage and water.

Postcode

NE66 1AT

Local Authority

Northumberland County Council

Tel: 0345 600 6400

Council Tax

Council Tax Band B - £1,777.74 - 2023/24

Tenure

Freehold



EPC Rating

Current Rating - C

Full report available upon request.

Viewing

Strictly by appointment with the selling agents.

Location

For detailed directions please contact the selling agents.

Details Prepared September 2023

Property Reference 8394470

Score	Energy rating	Current	Potential
92+	A		
81-91	B		88 B
69-80	C	70 C	
55-68	D		
39-54	E		
21-38	F		
1-20	G		



Ground Floor
Approx. 44.9 sq. metres (483.0 sq. feet)



First Floor
Approx. 40.4 sq. metres (434.7 sq. feet)

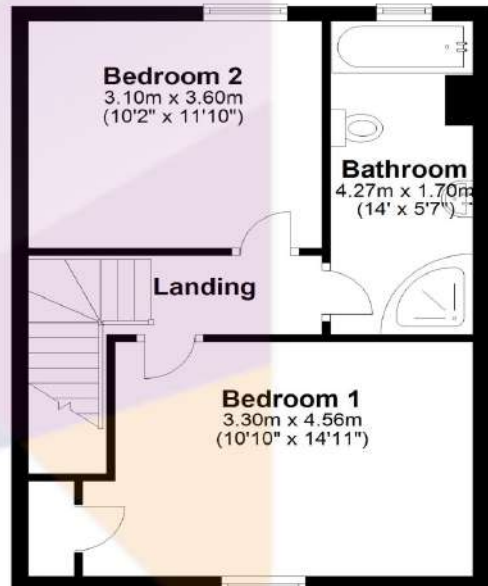

Total area: approx. 85.3 sq. metres (917.7 sq. feet)

Floor plan is approximate and is provided for visual reference only.
Plan produced using PlanUp.

Swansfield Park Road





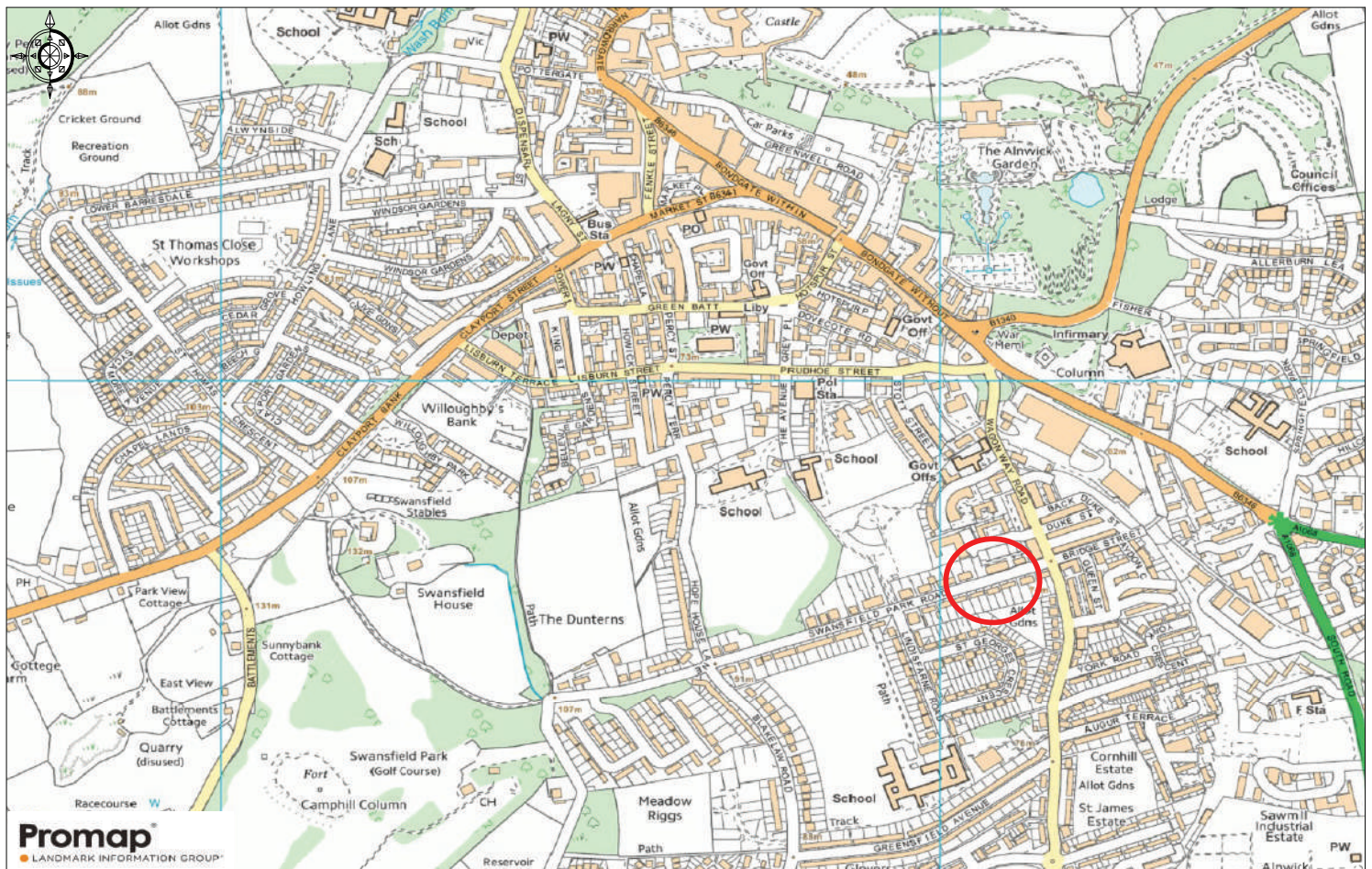

Ordnance Survey © Crown Copyright 2018. All rights reserved. Licence number 100022432. Plotted Scale - 1:10000

Townfoot, Rothbury, Morpeth NE65 7SP | info@ayrepropertyservices.co.uk | www.ayrepropertyservices.co.uk | 01669 621312

Important Notice

These particulars are intended only as a guide for prospective purchasers and do not constitute part of an or contract. All dimensions and other details are given in good faith and are believed to be correct but prospective purchasers should rely on their own measurements and representations of fact, but must satisfy themselves by inspection or otherwise as to their correctness. No responsibility can be accepted for expenses incurred by prospective purchasers in inspecting a property that has been sold or withdrawn from the market.