



One Bedroom Apartment, The Old Works, Leigh Street, High Wycombe, HP11 2WP

50% Shared Ownership | £105,000

Property Features

- One Bedroom Apartment
- 50% Shared Ownership
- Converted Historic Victorian Building
- Prime Central Location
- Light & Bright Apartment with High Ceilings and Tall Windows
- Contemporary Kitchen with Integrated Appliances
- Modern Bathroom
- Walking Distance to the Train Station
- Underground Allocated Parking
- Awaiting EPC / Awaiting Council Tax Band

Full Description

This one bedroom 50% shared ownership apartment is located within Birch House of The Old Works is where history and modern living seamlessly blend together. Nestled in the heart of High Wycombe, The Old Works is a celebration of the town's rich heritage and its promising future. This exceptional boutique style development has breathed new life into a splendid Victorian building, originally dedicated to the craft of chair making – a practice that High Wycombe is historically famous for.

As you enter No 26, you'll find yourself in a welcoming entrance space that leads you directly to the cosy bedroom, offering a tranquil room to relax and unwind. There is a large warehouse style window which adds to the charm of this converted industrial apartment. For your convenience, the fully tiled shower room features a pristine white suite, exuding a sense of elegance and cleanliness.

The heart of this apartment is the open-plan living room and kitchen, thoughtfully designed to create a seamless and inviting space. The large industrial-style windows, high ceilings and wooden flooring create a bright and airy space. Two built-in cupboards provide ample storage, ensuring a clutter-free living environment. The kitchen in this open-plan studio features modern integrated appliances, sleek cabinetry and ample countertop space for meal preparation.

50% Shared Ownership Price £105,000 (full price £210,000)

Rent on The Remaining 50% Share £241 per month

Service Charge £816 per annum Lease: 250 years

Enjoying a prime location that perfectly complements urban living, The Old Works is situated within walking distance of High Wycombe's vibrant town centre where residents can easily access a plethora of shops, bars, and restaurants. Whether you crave a leisurely stroll, a shopping spree, or a night out on the town, everything you desire is right at your doorstep.





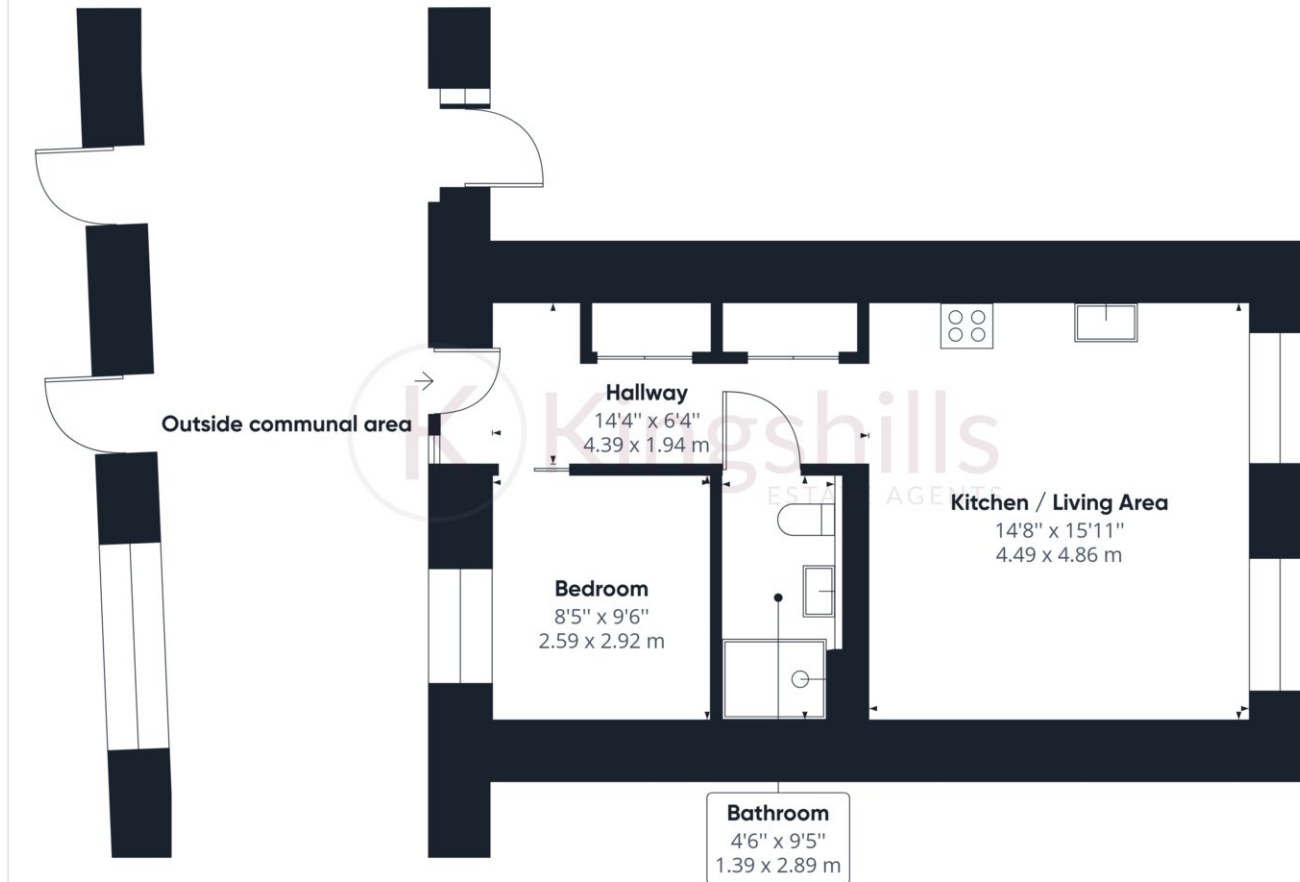

Approximate total area⁽¹⁾

485.43 ft²

45.10 m²

(1) Excluding balconies and terraces

While every attempt has been made to ensure accuracy, all measurements are approximate, not to scale. This floor plan is for illustrative purposes only.

GIRAFFE360