



£235,000

At a glance...



2



1



1

EPC

C

COUNCIL
TAX

B

**holland
& odam**

12 Serenity Rise
Street
Somerset
BA16 0FQ

TO VIEW

3 Farm Road, Street,
Somerset BA16 0BJ

01458 841411

street@hollandandodam.co.uk



Directions

From the town centre proceed in a westerly direction passing Living Homes on the right. Continue along passing Abbey Garage on the left and shortly after passing the Morrisons Daily convenience store also on the left, turn right into the Icon development. Turn right again into Lime Tree Square, then take a left into Couture Grove after a short distance turn left into Serenity Rise and the property will be easily identified by our For Sale Board.

Services

Mains electricity, gas, water and drainage are connected. Gas central heating system.

For information regarding broadband and mobile coverage, go to checker.offcom.org.uk

Local Authority

Somerset Council
0300 1232224
somerset.gov.uk

Tenure

Freehold
Estate/Management Charges £280 p.a.



Location

The property is situated within walking distance of the town centre with its good range of shops, banks and cafes. Street also has a good range of sporting and recreational facilities including both indoor and open air swimming pools, tennis, bowls, and Strode Theatre. The historic town of Glastonbury is 2 miles and the Cathedral City of Wells 8 miles. The nearest M5 motorway interchange at Dunball (Junction 23) is 12 miles whilst Bristol, Bath, Taunton and Yeovil are all within commuting distance.

Insight

A spacious town house, designed and built in a contemporary style, providing two bedrooms and a bathroom on the first floor, with a kitchen/dining room, sitting room and cloakroom on the ground floor. Outside, there is parking available to the integral garage with an enclosed garden at the rear.

- Open recessed front entrance porch with door opening into a kitchen/dining room.
- Fitted with a modern range of units including an integrated electric oven and gas hob. Space and plumbing for a washing machine and upright fridge freezer
- Opening to the hall with stairs to 1st floor, under stairs cupboard, cloakroom on the right and continuing into the sitting room.
- Here there are double doors and the window looks onto the rear garden
- First floor landing with doors to the two bedrooms, bathroom and double doors opening onto the first floor Terrace
- Bedroom one has windows to the side and rear with bed two having a front facing aspect looking out over the green.
- Family bathroom comprising panelled bath with shower over, wash hand basin and WC
- Outside, there is parking in front of the integral garage which has a pedestrian door into the rear garden.



GROUND FLOOR

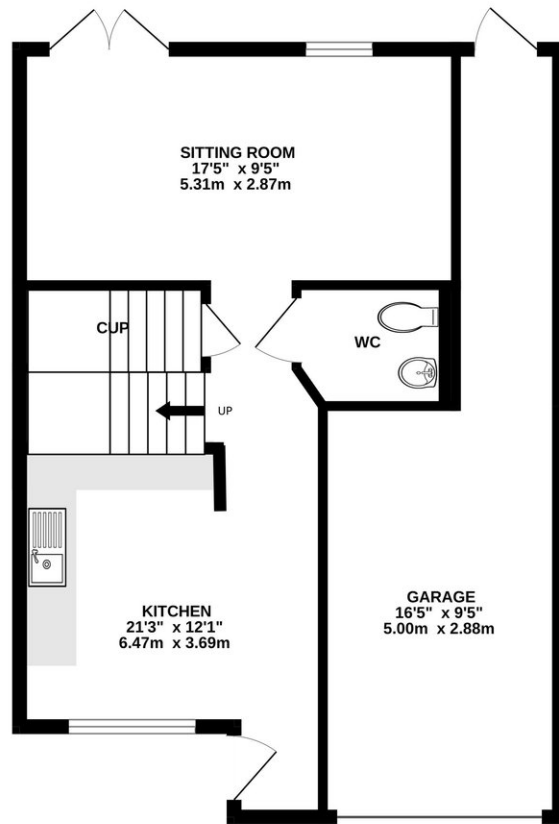

1ST FLOOR

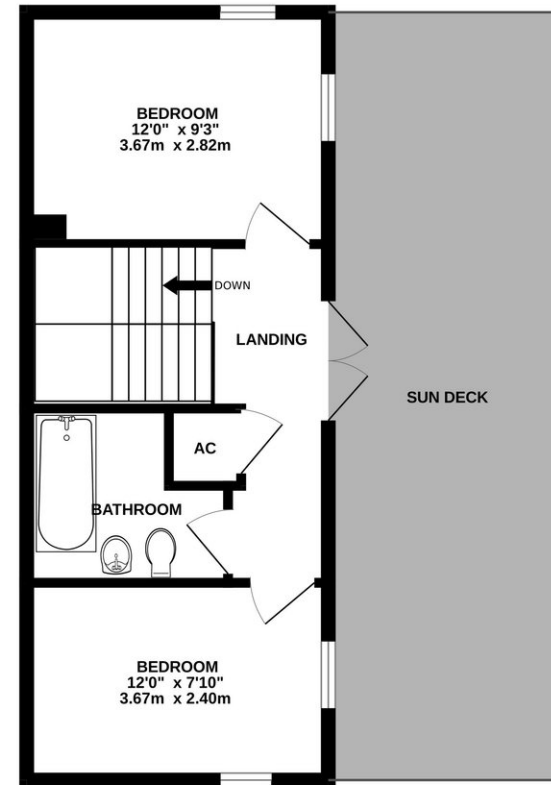

Whilst every attempt has been made to ensure the accuracy of the floorplan contained here, measurements of doors, windows, rooms and any other items are approximate and no responsibility is taken for any error, omission or mis-statement. This plan is for illustrative purposes only and should be used as such by any prospective purchaser. The services, systems and appliances shown have not been tested and no guarantee as to their operability or efficiency can be given.
Made with Metropix ©2024

DISCLAIMER

CONSUMER PROTECTION FROM UNFAIR TRADING REGULATIONS 2008. The Agent has not tested any apparatus, equipment, fixtures and fittings or services and so cannot verify that they are in working order or fit for the purpose. A Buyer is advised to obtain verification from their Solicitor or Surveyor. References to the Tenure of a Property are based on information supplied by the Seller. The Agent has not had sight of the

title documents. A Buyer is advised to obtain verification from their Solicitor. Items shown in photographs are not included unless specifically mentioned within the sales particulars. They may however be available by separate negotiation. Buyers must check the availability of any property and make an appointment to view before embarking on any journey to see a property.

DATA PROTECTION. Personal information provided by customers wishing to receive information and/or services from the estate agent and the Property Sharing Experts (of which it is a member) for the purpose of providing services associated with the business of an estate agent but specifically excluding mailing or promotions by a third party. If you do not wish your personal information to be used for any of these purposes, please notify us.