

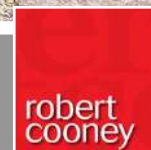

7 Lloyd Close Taunton TA1 5QU

£275,000



A well-presented 3 bedroomed link-detached house in the heart of Galmington within Castle School catchment and easy reach of Musgrove Park Hospital, with enclosed garden to rear and driveway parking.





Features

- Entrance hall
- Living room
- Family room with door to garden
- Fitted kitchen / breakfast room
- Utility room
- Cloakroom
- Master bedroom
- 2 further bedrooms, bedroom 2 with fitted wardrobe
- Family bathroom

- Enclosed garden to rear
- Driveway parking
- Gas fired central heating

- Double glazing
- Castle School catchment

- Council tax band D



GROUND FLOOR
515 sq.ft. (47.8 sq.m.) approx.

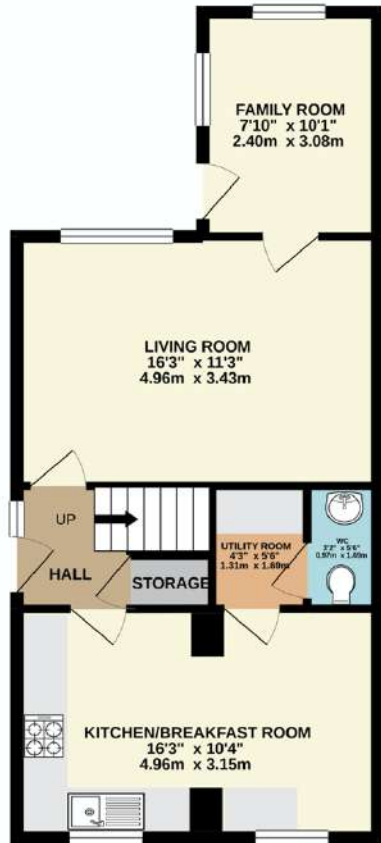

1ST FLOOR
444 sq.ft. (41.2 sq.m.) approx.



TOTAL FLOOR AREA: 958 sq.ft. (89.0 sq.m.) approx.

Whilst every attempt has been made to ensure the accuracy of the floorplan contained here, measurements of doors, windows, rooms and any other items are approximate and no responsibility is taken for any error, omission or mis-statement. This plan is for illustrative purposes only and should be used as such by any prospective purchaser. The services, systems and appliances shown have not been tested and no guarantee as to their operability or efficiency can be given.
Made with Metropro ©2021

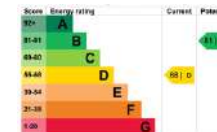

Viewing strictly through the selling agents:

Robert Cooney

Corporation Street, Taunton,
Somerset TA1 4AW

Telephone 01823 230 230

E-mail taunton@robertcooney.co.uk

Website www.robertcooney.co.uk



For clarification, we wish to inform prospective purchasers that: these particulars are set out as a general outline only for the guidance of intended purchasers, and do not constitute, nor constitute part of, an offer or contract; all descriptions, dimensions, references to condition and necessary permission for use and occupation, and other details, are given without responsibility and any intending purchasers should not rely on them as statements or representation of fact, but must satisfy themselves by inspection or otherwise as to the correctness of each of them; no person in the employment of Robert Cooney has any authority to make or give any representation or warranty whatever in relation to this property; we have not carried out a detailed survey nor tested the services, appliances and specific fittings.

**robert
cooney**