



23 Alexandra Park, High Wycombe, Buckinghamshire, HP11 2HB

Asking Price | £180,000



## Property Description

This 1st floor apartment situated in High Wycombe is a perfect home for young professionals and first-time buyers. It is conveniently located within walking distance of the town centre, providing easy access to all the daily essentials. This apartment boasts 1 double bedroom, 1 bathroom and a light and airy living room with a balcony. The apartment comprises a modern kitchen fitted with appliances, contemporary flooring and ample storage space. The bathroom is fully equipped with a bathtub and overhead shower.

The property comes with no onward chain, ideal for anyone looking to move quickly. The balcony provides an excellent space to relax and unwind after a long day while enjoying the panoramic views of the locality.

High Wycombe is a bustling town situated in the south of Buckinghamshire, near the Chiltern Hills. The town offers many things to do for residents and visitors, including the Wycombe Swan Theatre, which hosts a variety of shows, live music, and comedy performances. Wycombe Museum offers a glimpse into the town's past, while Hughenden Manor, the former home of Prime Minister Benjamin Disraeli, is now a National Trust property and a fantastic day out.

For those who enjoy outdoor activities, the Chiltern Hills AONB is just a short drive away and provides a beautiful backdrop for hiking, cycling, and exploring the great outdoors. Shopping enthusiasts will be pleased to know that High Wycombe has a vast shopping centre, Eden Centre, offering high-end shops and variety of restaurants. Lastly, local football team, Wycombe Wanderers FC, provides an excellent opportunity for sports lovers to catch a game of football.

Tenure Leasehold

Lease: 125 years from 24th June 1992

Service Charge: £1,275.00 per annum

Ground Rent: £260.00 per annum

Awaiting EPC / Council Tax Band B

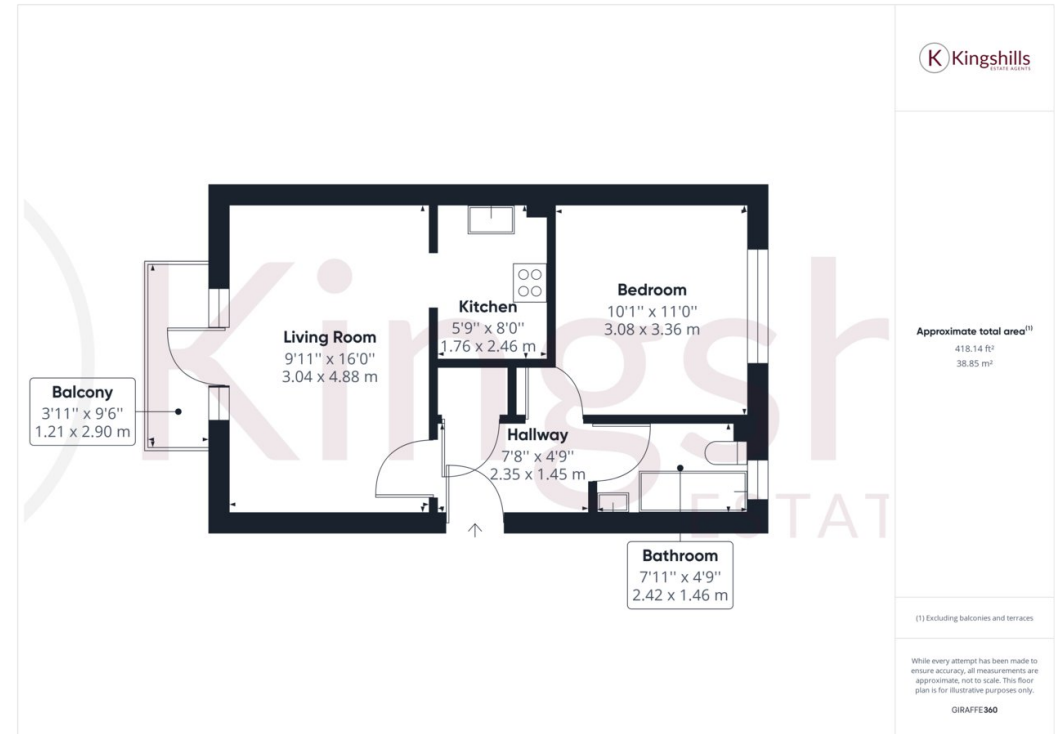

Kingshills Estate Agents  
Comet Studios  
Amersham  
Buckinghamshire  
HP7 0PX

01494 939868  
hello@kingshills.co.uk  
kingshills.co.uk

Agents Note: Whilst every care has been taken to prepare these particulars, they are for guidance purposes only. All measurements are for general guidance purposes only and whilst every care has been taken to ensure accuracy, they should not be relied upon and potential buyers/tenants are advised to recheck the measurements