



Property Features

- Four Bedroom Detached Family Home
- Peaceful Location
- Garage and Driveway Parking
- Picturesque Garden with Stream
- Two Reception Rooms
- Modern Kitchen/Diner
- Utility Room
- Within Walking Distance to Princes Risborough Train Station
- Close to Local Schools for all Ages
- Perfect Family Home

Full Description

We are delighted to bring to the market this four-bedroom detached family home in the charming town of Princes Risborough, Buckinghamshire. This stunning detached house is available for rent and offers a perfect blend of modern living and classic charm. With a spacious interior, a picturesque garden, and overlooking the neighborhood green, this property is ideal for families looking for a comfortable and stylish home.

The internal of the property offers light and airy accommodation throughout. The ground floor of the property offers a spacious living room which looks out to the front of the property, downstairs WC, dining room/snug with doors to the garden and a modern kitchen/dining area with a separate utility room. The kitchen offers a range of appliances and is the heart of the home, perfect for entertaining and spending time with the family. The 1st floor offers four well-proportioned bedrooms and a modern family bathroom.

Outside, you will find the enchanting rear garden, which features a picturesque stream running through it. The garden is a haven for nature lovers and provides a private and tranquil escape which enjoys borrowed landscape from the neighbouring gardens. To the front of the property offers a garage and driveway parking for 2 cars.

Princes Risborough is a delightful town nestled in the beautiful Buckinghamshire countryside. Within a short walk from the property, you can explore the charming High Street with its boutique shops, cafes, and restaurants. The surrounding countryside offers numerous walking and hiking trails, including the Ridgeway National Trail and the Chiltern Hills. Princes Risborough is well-connected by rail and road, within walking distance of this property you will find the train station, which connects to London Marylebone in just over 40 minutes.

Princes Risborough also benefits from well-respected local schools for all ages, making this the ideal family home.

This detached house for rent in Princes Risborough offers an inviting lifestyle with its modern amenities and access to the town's delightful attractions. Don't miss the opportunity to make this property your new home.









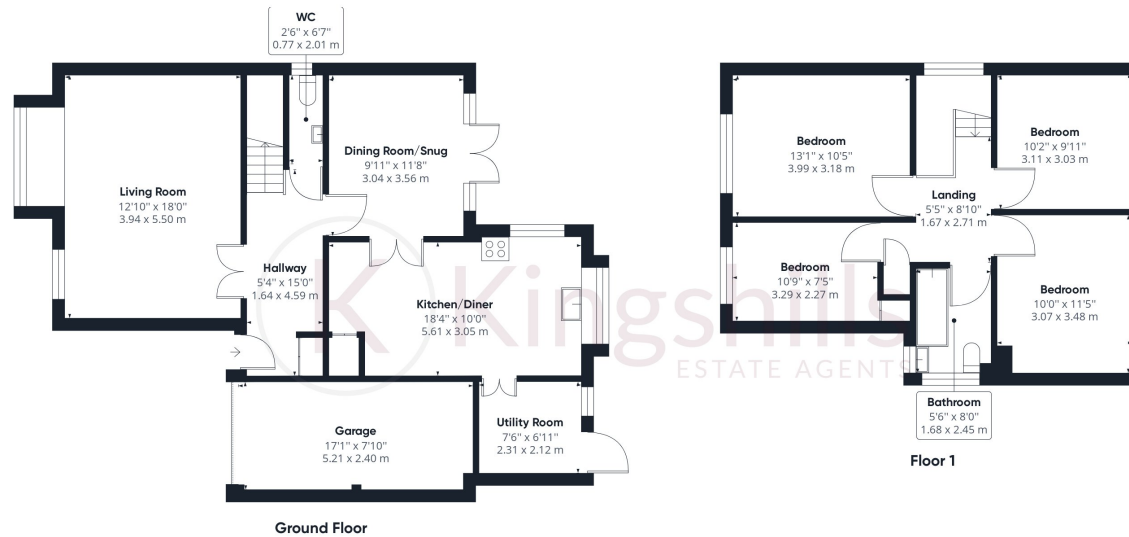

Approximate total area⁽¹⁾

1425.03 ft²
132.39 m²

(1) Excluding balconies and terraces

While every attempt has been made to ensure accuracy, all measurements are approximate, not to scale. This floor plan is for illustrative purposes only.

GIRAFFE360