



20A ST MICHAELS LANE  
ALNWICK

AYRE  
PROPERTY  
SERVICES

01669 621312  
[ayrepropertieservices.co.uk](http://ayrepropertieservices.co.uk)

£100,000

GUIDE  
PRICE

An extremely pleasant first floor apartment situated opposite the church close to the centre of Alnwick. The apartment has One Bedroom. The property has a cleverly designed space saving kitchen and modern Shower Room. It would be suitable as a first-time buy, or as a buy-to-let investment. Accommodation comprises Sitting Room/Kitchen, Bedrooms and Bathroom. Access to a Ground Floor patio area (shared with other residents).

## Alnwick

Awareness of the Alnwick District has grown significantly in the last few years. The Duchess of Northumberland's Gardens and the mysterious village of Lilidorei at Alnwick Castle are now internationally known and have provoked much interest in the town. Alnwick is well served by the A1 and the east coast mainline railway (providing links to Edinburgh, Newcastle and London) and is within easy reach of the stunning Northumberland coast, the Cheviot Hills and the Scottish Borders

## Services

Mains electricity, gas, drainage and water.

## Postcode

NE66 1TW

## Local Authority

Northumberland County Council  
Tel: 0345 600 6400

## Council Tax

Council Tax Band A- £1,523.76 - 2023/24

## Tenure

Freehold

## EPC Rating

Current Rating - D

Full report available upon request.

## Viewing

Strictly by appointment with the selling agents.

## Location

For detailed directions please contact the selling agents.

Details Prepared      October 2023

Property Reference 81130482



Score	Energy rating	Current	Potential
92+	A		
81-91	B		
69-80	C		77 C
55-68	D	56 D	
39-54	E		
21-38	F		
1-20	G		





### Second Floor

Approx. 40.4 sq. metres (434.4 sq. feet)

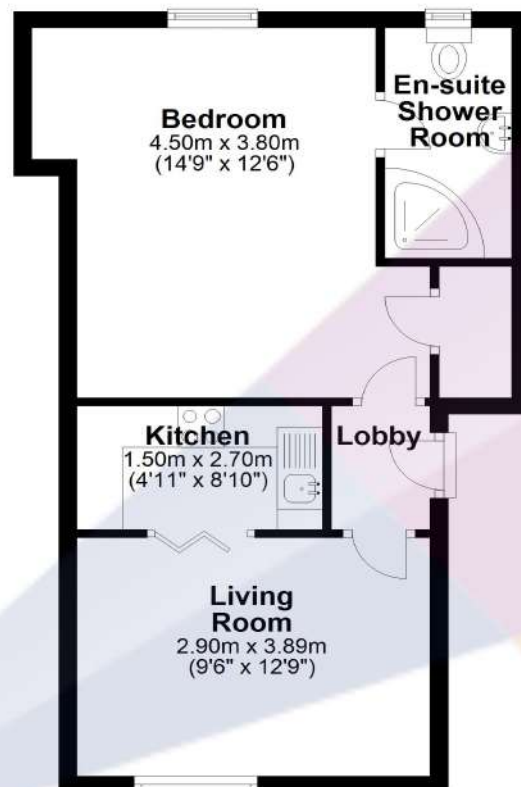

Total area: approx. 40.4 sq. metres (434.4 sq. feet)

Floor plan is approximate and is provided for visual reference only.  
Plan produced using PlanUp.

**St Michaels Lane**













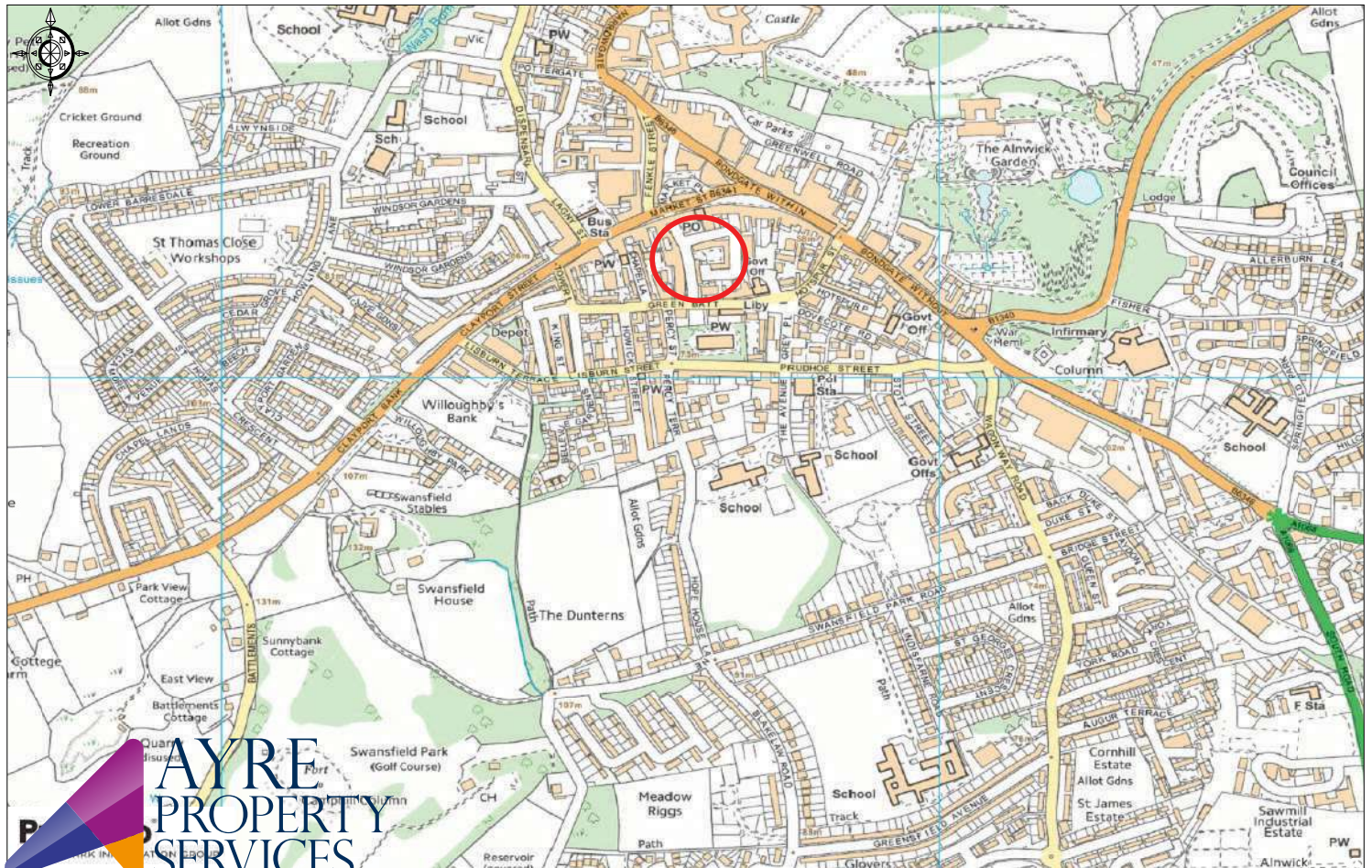

**AYRE**  
PROPERTY  
SERVICES

Ordnance Survey © Crown Copyright 2018. All rights reserved. Licence number 100022432. Plotted Scale - 1:10000

Townfoot, Rothbury, Morpeth NE65 7SP | [info@ayrepropertieservices.co.uk](mailto:info@ayrepropertieservices.co.uk) | [www.ayrepropertieservices.co.uk](http://www.ayrepropertieservices.co.uk) | 01669 621312