

HOME

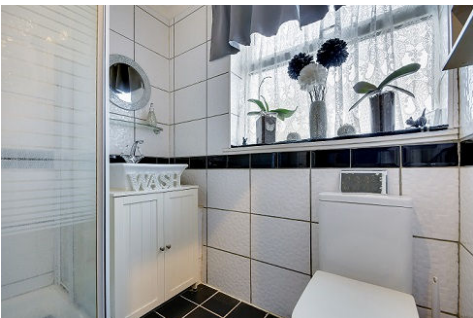

Chelmer Village
Offers Over £275,000
2-bed semi detached bungalow

Woodroffe Close

Situated in a popular residential location close to all local amenities is this well-maintained two bedroom semi detached, bungalow.

The accommodation comprises an entrance lobby with a door leading to a lounge/diner. Accessed off of this room is a kitchen. To the rear of the property there are two double bedrooms, as well as a shower room WC.

There are gardens to the front and rear of the property and in addition, there is an allocated parking space as well as a garage in a nearby block. This property is double glazed and has gas fired radiator central heating.

Chelmer Village is located on the outskirts of the City with a regular bus service to the Railway Station with trains to London . Stratford from 31 minutes and Liverpool Street from 36 minutes. The property is within walking distance of the local shopping square which has an ASDA superstore and Subway sandwich shop. There are two sought after Primary Schools and two local restaurants/taverns situated near by as well as River walks along the River Chelmer towards Boreham, Little Baddow and beyond.

Chelmsford
11 Duke Street
Essex CM1 1HL

Sales
01245 250 222
Lettings
01245 253 377
Mortgages
01245 253 370

thehomepartnership.co.uk

Ground Floor

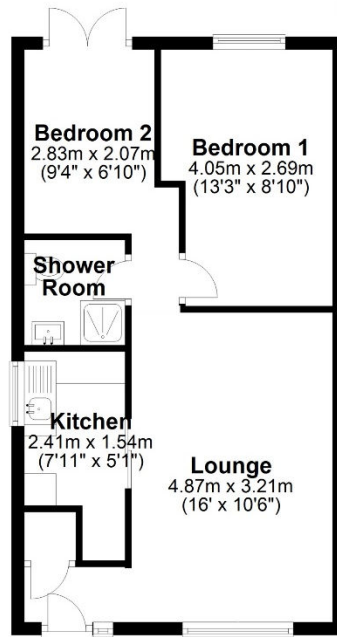

TOTAL APPROX INTERNAL FLOOR AREA
43 SQ M 466 SQ FT
 This plan is for layout guidance only and is
NOT TO SCALE
 Whilst every care is taken in the preparation
 of this plan, please check all dimensions,
 shapes & compass bearings before making
 any decisions reliant upon them.
Copyright

HOME

Features

- Convenient for Asda superstore
- Two double bedrooms
- Shower room/WC
- Double glazed
- Gas radiator central heating
- Garage in nearby block
- Front & rear gardens
- Allocated parking space
- Good access to A12 & A130
- Approx. 1.6 miles to City centre

EPC Rating

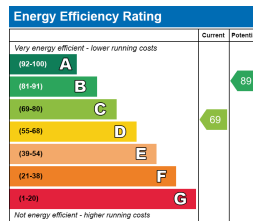

The Nitty Gritty

Tenure: Freehold

Band C is the Council Tax band for this property and the annual council tax bill is £1,817.20

As an integral part of the community, we've gotten to know the best professionals for the job. If we recommend one to you, it will be in good faith that they'll make the process as smooth as can be. Please be aware that a small number of the parties we recommend (certainly not the majority) may on occasion pay us a referral fee up to £200. You are under no obligation to use a third party we have recommended.



HOME

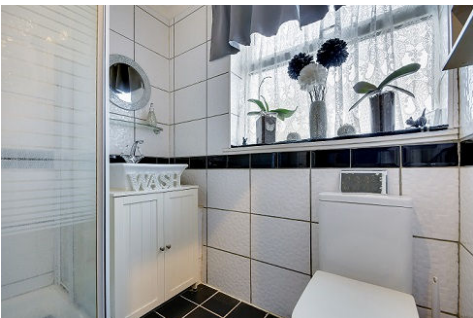

Chelmer Village
Offers Over £275,000
2-bed semi detached bungalow

Woodroffe Close

Situated in a popular residential location close to all local amenities is this well-maintained two bedroom semi detached, bungalow.

The accommodation comprises an entrance lobby with a door leading to a lounge/diner. Accessed off of this room is a kitchen. To the rear of the property there are two double bedrooms, as well as a shower room WC.

There are gardens to the front and rear of the property and in addition, there is an allocated parking space as well as a garage in a nearby block. This property is double glazed and has gas fired radiator central heating.

Chelmer Village is located on the outskirts of the City with a regular bus service to the Railway Station with trains to London . Stratford from 31 minutes and Liverpool Street from 36 minutes. The property is within walking distance of the local shopping square which has an ASDA superstore and Subway sandwich shop. There are two sought after Primary Schools and two local restaurants/taverns situated near by as well as River walks along the River Chelmer towards Boreham, Little Baddow and beyond.

Chelmsford
11 Duke Street
Essex CM1 1HL

Sales
01245 250 222
Lettings
01245 253 377
Mortgages
01245 253 370

thehomepartnership.co.uk

Ground Floor

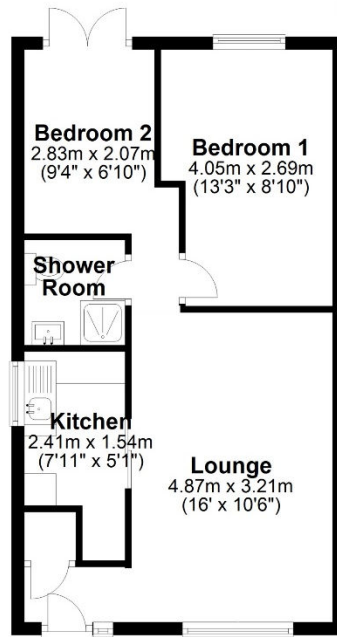

TOTAL APPROX INTERNAL FLOOR AREA
43 SQ M 466 SQ FT
 This plan is for layout guidance only and is
NOT TO SCALE
 Whilst every care is taken in the preparation
 of this plan, please check all dimensions,
 shapes & compass bearings before making
 any decisions reliant upon them.
Copyright

HOME

Features

- Convenient for Asda superstore
- Two double bedrooms
- Shower room/WC
- Double glazed
- Gas radiator central heating
- Garage in nearby block
- Front & rear gardens
- Allocated parking space
- Good access to A12 & A130
- Approx. 1.6 miles to City centre

EPC Rating

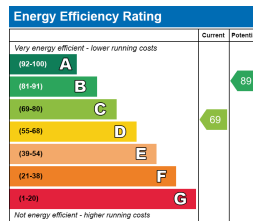

The Nitty Gritty

Tenure: Freehold

Band C is the Council Tax band for this property and the annual council tax bill is £1,817.20

As an integral part of the community, we've gotten to know the best professionals for the job. If we recommend one to you, it will be in good faith that they'll make the process as smooth as can be. Please be aware that a small number of the parties we recommend (certainly not the majority) may on occasion pay us a referral fee up to £200. You are under no obligation to use a third party we have recommended.



HOME

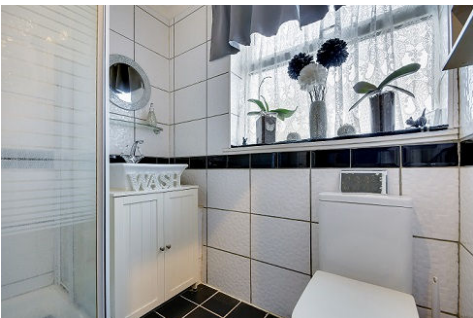

Chelmer Village
Offers Over £275,000
2-bed semi detached bungalow

Woodroffe Close

Situated in a popular residential location close to all local amenities is this well-maintained two bedroom semi detached, bungalow.

The accommodation comprises an entrance lobby with a door leading to a lounge/diner. Accessed off of this room is a kitchen. To the rear of the property there are two double bedrooms, as well as a shower room WC.

There are gardens to the front and rear of the property and in addition, there is an allocated parking space as well as a garage in a nearby block. This property is double glazed and has gas fired radiator central heating.

Chelmer Village is located on the outskirts of the City with a regular bus service to the Railway Station with trains to London . Stratford from 31 minutes and Liverpool Street from 36 minutes. The property is within walking distance of the local shopping square which has an ASDA superstore and Subway sandwich shop. There are two sought after Primary Schools and two local restaurants/taverns situated near by as well as River walks along the River Chelmer towards Boreham, Little Baddow and beyond.

Chelmsford
11 Duke Street
Essex CM1 1HL

Sales
01245 250 222
Lettings
01245 253 377
Mortgages
01245 253 370

thehomepartnership.co.uk

Ground Floor

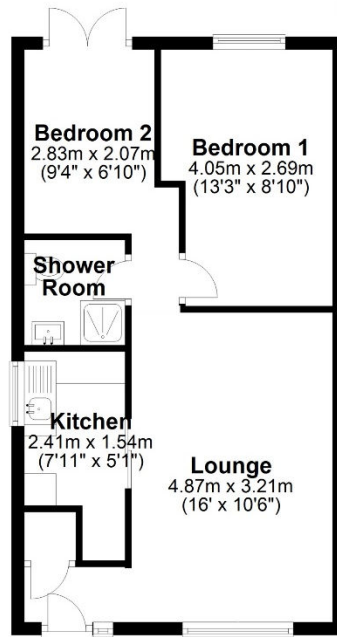

TOTAL APPROX INTERNAL FLOOR AREA
43 SQ M 466 SQ FT
 This plan is for layout guidance only and is
NOT TO SCALE
 Whilst every care is taken in the preparation
 of this plan, please check all dimensions,
 shapes & compass bearings before making
 any decisions reliant upon them.
Copyright

HOME

Features

- Convenient for Asda superstore
- Two double bedrooms
- Shower room/WC
- Double glazed
- Gas radiator central heating
- Garage in nearby block
- Front & rear gardens
- Allocated parking space
- Good access to A12 & A130
- Approx. 1.6 miles to City centre

EPC Rating

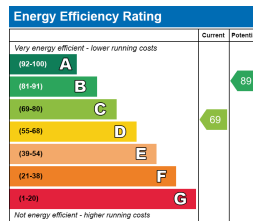

The Nitty Gritty

Tenure: Freehold

Band C is the Council Tax band for this property and the annual council tax bill is £1,817.20

As an integral part of the community, we've gotten to know the best professionals for the job. If we recommend one to you, it will be in good faith that they'll make the process as smooth as can be. Please be aware that a small number of the parties we recommend (certainly not the majority) may on occasion pay us a referral fee up to £200. You are under no obligation to use a third party we have recommended.



HOME



Chelmer Village
Offers Over £275,000
2-bed semi detached bungalow

Woodroffe Close

Situated in a popular residential location close to all local amenities is this well-maintained two bedroom semi detached, bungalow.

The accommodation comprises an entrance lobby with a door leading to a lounge/diner. Accessed off of this room is a kitchen. To the rear of the property there are two double bedrooms, as well as a shower room WC.

There are gardens to the front and rear of the property and in addition, there is an allocated parking space as well as a garage in a nearby block. This property is double glazed and has gas fired radiator central heating.

Chelmer Village is located on the outskirts of the City with a regular bus service to the Railway Station with trains to London . Stratford from 31 minutes and Liverpool Street from 36 minutes. The property is within walking distance of the local shopping square which has an ASDA superstore and Subway sandwich shop. There are two sought after Primary Schools and two local restaurants/taverns situated near by as well as River walks along the River Chelmer towards Boreham, Little Baddow and beyond.

Chelmsford
11 Duke Street
Essex CM1 1HL

Sales
01245 250 222
Lettings
01245 253 377
Mortgages
01245 253 370

thehomepartnership.co.uk

Ground Floor

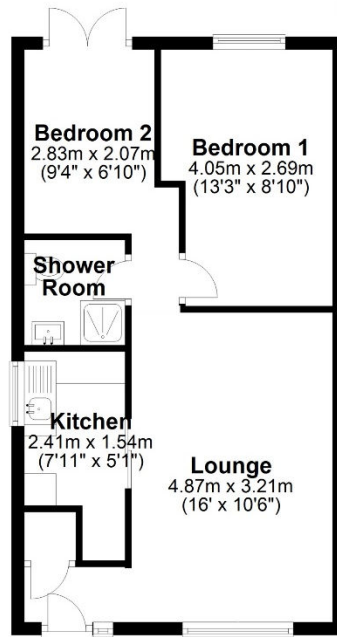

TOTAL APPROX INTERNAL FLOOR AREA
43 SQ M 466 SQ FT

This plan is for layout guidance only and is
NOT TO SCALE

Whilst every care is taken in the preparation
of this plan, please check all dimensions,
shapes & compass bearings before making
any decisions reliant upon them.

Copyright

HOME

Features

- Convenient for Asda superstore
- Two double bedrooms
- Shower room/WC
- Double glazed
- Gas radiator central heating
- Garage in nearby block
- Front & rear gardens
- Allocated parking space
- Good access to A12 & A130
- Approx. 1.6 miles to City centre

EPC Rating

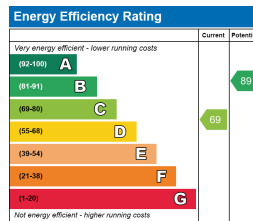

The Nitty Gritty

Tenure: Freehold

Band C is the Council Tax band for this property and the annual council tax bill is £1,817.20

As an integral part of the community, we've gotten to know the best professionals for the job. If we recommend one to you, it will be in good faith that they'll make the process as smooth as can be. Please be aware that a small number of the parties we recommend (certainly not the majority) may on occasion pay us a referral fee up to £200. You are under no obligation to use a third party we have recommended.



HOME

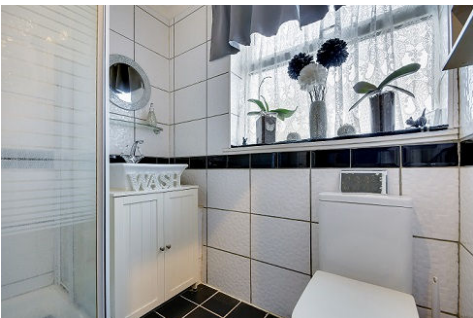

Chelmer Village
Offers Over £275,000
2-bed semi detached bungalow

Woodroffe Close

Situated in a popular residential location close to all local amenities is this well-maintained two bedroom semi detached, bungalow.

The accommodation comprises an entrance lobby with a door leading to a lounge/diner. Accessed off of this room is a kitchen. To the rear of the property there are two double bedrooms, as well as a shower room WC.

There are gardens to the front and rear of the property and in addition, there is an allocated parking space as well as a garage in a nearby block. This property is double glazed and has gas fired radiator central heating.

Chelmer Village is located on the outskirts of the City with a regular bus service to the Railway Station with trains to London . Stratford from 31 minutes and Liverpool Street from 36 minutes. The property is within walking distance of the local shopping square which has an ASDA superstore and Subway sandwich shop. There are two sought after Primary Schools and two local restaurants/taverns situated near by as well as River walks along the River Chelmer towards Boreham, Little Baddow and beyond.

Chelmsford
11 Duke Street
Essex CM1 1HL

Sales
01245 250 222
Lettings
01245 253 377
Mortgages
01245 253 370

thehomepartnership.co.uk

Ground Floor

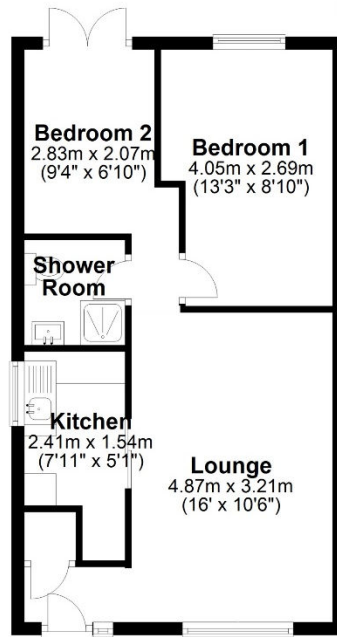

TOTAL APPROX INTERNAL FLOOR AREA
43 SQ M 466 SQ FT
 This plan is for layout guidance only and is
NOT TO SCALE
 Whilst every care is taken in the preparation
 of this plan, please check all dimensions,
 shapes & compass bearings before making
 any decisions reliant upon them.
Copyright

HOME

Features

- Convenient for Asda superstore
- Two double bedrooms
- Shower room/WC
- Double glazed
- Gas radiator central heating
- Garage in nearby block
- Front & rear gardens
- Allocated parking space
- Good access to A12 & A130
- Approx. 1.6 miles to City centre

EPC Rating

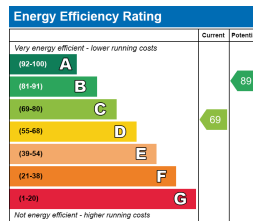

The Nitty Gritty

Tenure: Freehold

Band C is the Council Tax band for this property and the annual council tax bill is £1,817.20

As an integral part of the community, we've gotten to know the best professionals for the job. If we recommend one to you, it will be in good faith that they'll make the process as smooth as can be. Please be aware that a small number of the parties we recommend (certainly not the majority) may on occasion pay us a referral fee up to £200. You are under no obligation to use a third party we have recommended.

