



69 Deane Drive Galmington, Taunton TA1 5PP

OIEO £250,000



69 Deane Drive, Taunton, TA1 5PP

Approximate Area = 582 sq ft / 54 sq m

Garage = 144 sq ft / 13.3 sq m

Total = 726 sq ft / 67.3 sq m

For identification only - Not to scale

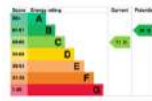
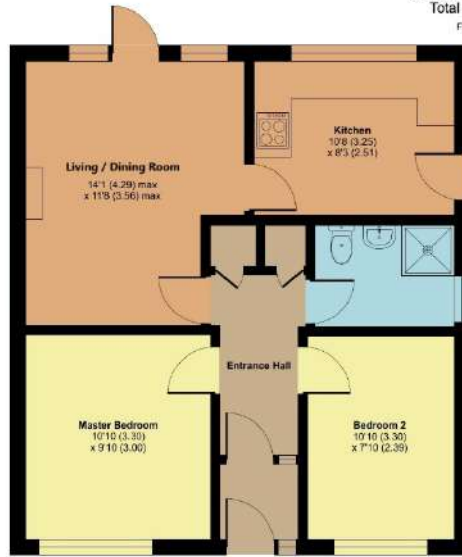

Floor plan produced in accordance with RICS Property Measurement Standards incorporating International Property Measurement Standards (IPMS Residential) © rics.com 2023. Produced for Robert Cooney, REF: 1620731

Features

- Entrance Hall
- Living Room with door to garden
- Fitted Kitchen
- Master Bedroom
- Further Bedroom
- Shower Room
- West facing enclosed garden to rear and good sized garden to front
- Garage and driveway parking
- Gas central heating
- Double glazing
- Castle School catchment
- Council tax band C
- What3words: [///mining.sock.larger](#)

A well-presented 2 bedroom semi-detached bungalow in this convenient location just over 1.5 miles from the town centre with charming enclosed West facing garden to the rear, garage, garden & driveway parking to the front.



Viewing strictly through the selling agents:

Robert Cooney

Corporation Street, Taunton,
Somerset TA1 4AW

Telephone 01823 230 230

E-mail taunton@robertcooney.co.uk

Website www.robertcooney.co.uk

**robert
cooney**