



WILMSLOW ROAD

Wilmslow

WILMSLOW ROAD

Wilmslow

- Fully Renovated
- Large Dining Kitchen
- 3/4 Bedrooms
- Character and Charm
- Sought after location





WILMSLOW ROAD

Maison Haus present to you this beautiful Grade II Listed property dating back to the 1700's, one of the oldest private dwellings in the area benefitting from a sympathetic restoration throughout.

The current owners have worked in collaboration with English Heritage to lovingly transform the property using traditional techniques whilst incorporating materials true to its Grade II Listing.





The current owners have worked in collaboration with English Heritage to lovingly transform the property using traditional techniques whilst incorporating materials true to its Grade II Listing.

The property occupies a gated, large mature garden plot extending to approximately 0.5 acres with the necessary consents could provide an exciting opportunity for those who may want to develop the land with the relevant permissions.



Internally the property has been finished to an exceptionally high standard throughout with a focus on the original period features whilst combining a modern layout to suit the busy family.

At the heart of the home you will find the open plan kitchen with a large island, dining and sitting room with garden views and a separate utility/boot room off the kitchen. The accommodation can be flexible to suit with three first floor bedrooms and the fourth or home office to the ground floor.

The master bedroom has fully fitted wardrobes and an en-suite with walk in shower and twin basin. The second bedroom also benefitting from twin basin and en-suite finished to an impeccable standard. The remaining bedrooms enjoy the three piece bathroom suite.











Ground Floor

Approx. 114.7 sq. metres (1234.7 sq. feet)

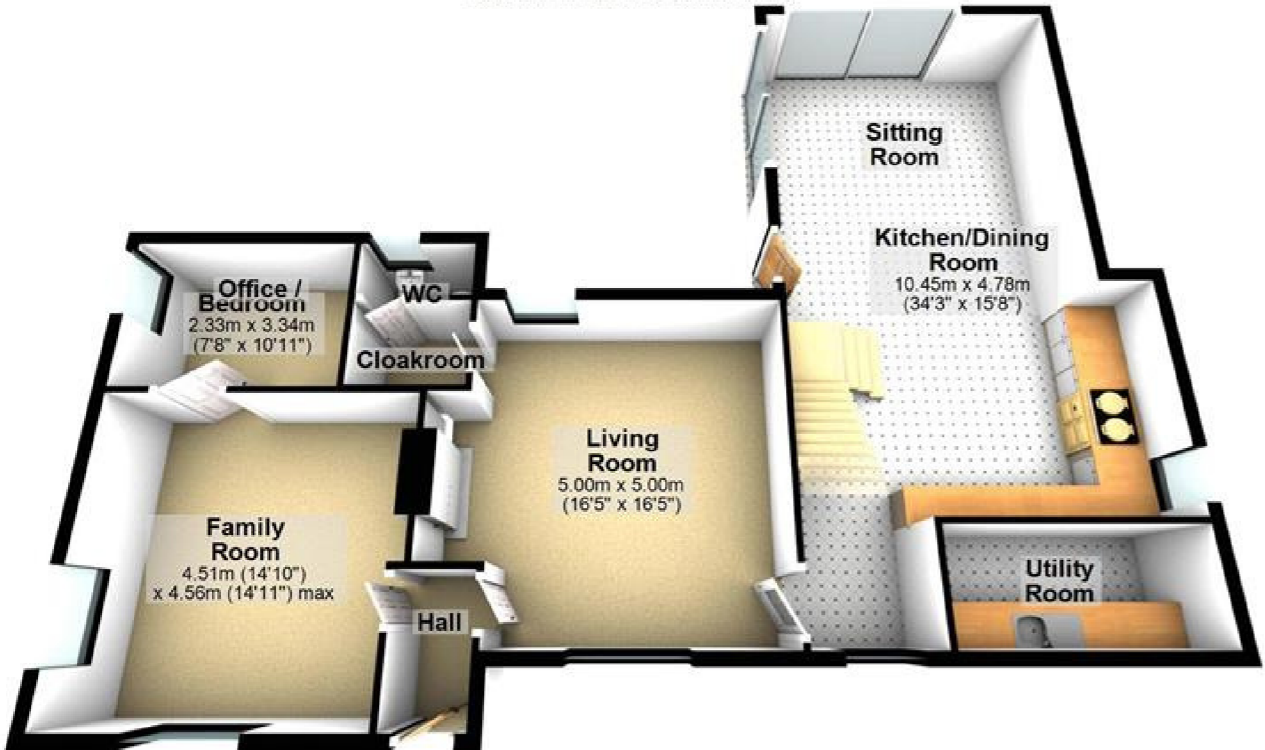

First Floor

Approx. 108.7 sq. metres (1170.3 sq. feet)

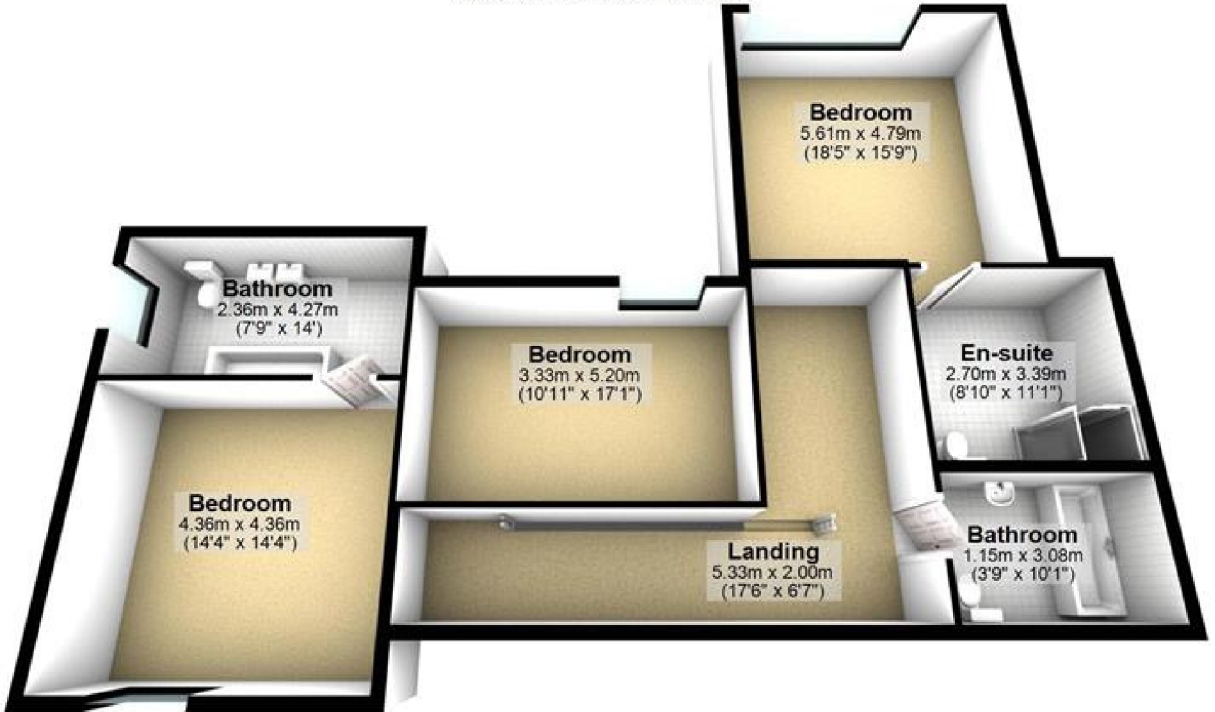

**187 Wilmslow Road
Wilmslow
SK9 3JX**

Asking Price: £1,100,000

Tenure: Freehold (to be confirmed by solicitors)

Local Authority: Cheshire East

EPC Rating: E

CONTACT US:

📍 Mill Lane, Alderley Edge, Cheshire, SK9 7TY

✉ Moving@Maison.Haus

📞 01625 919 079



Important Notice:

Maison Haus Limited, their solicitors and joint agents give notice that:

1. They are not authorised to make or give any representations or warranties in relation to the property either here or elsewhere, either on their own behalf or on behalf of their client or otherwise. They assume no responsibility for any statement that may be made in these particulars. These particulars do not form part of any offer or contract and must not be relied upon as statements or representation of fact.

2. Any areas, measurements or distances are approximate. The text, photographs and plans are for guidance only and are not necessarily comprehensive. It should not be assumed that the property has all necessary planning, building regulations or other consents and Maison Haus Limited have not tested any services, equipment or facilities. Purchasers must satisfy themselves by inspection or otherwise.