



52 Whitley Mead, BS34 8XT

Stoke Gifford



The ground floor offers an entrance hall, cloakroom, storage, kitchen, sitting room with an opening to the conservatory and patio doors leading to the rear garden. Above you can find 3 bedrooms and a family bathroom. Furthermore the property benefits from gas central heating, double glazed windows, rear garden and allocated parking.

- Whitley Mead • 3 Bedrooms • Terraced • Gas Central Heating • Conservatory • Off Street Parking • Cloakroom • Rear Garden • Tenure- freehold • EPC Rating- C •



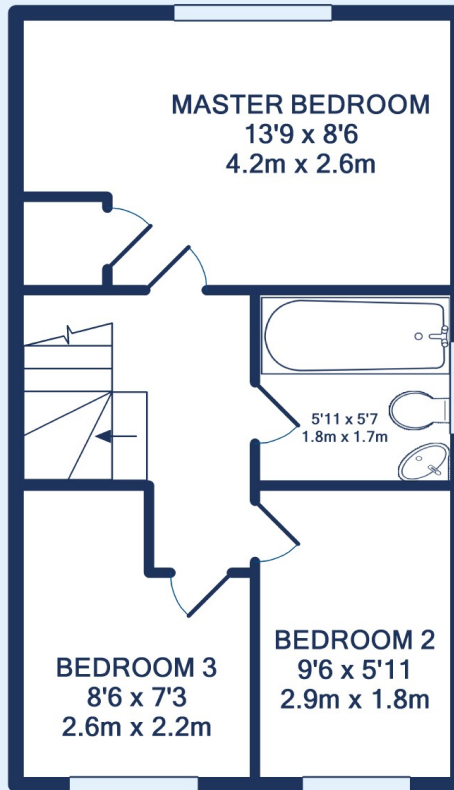
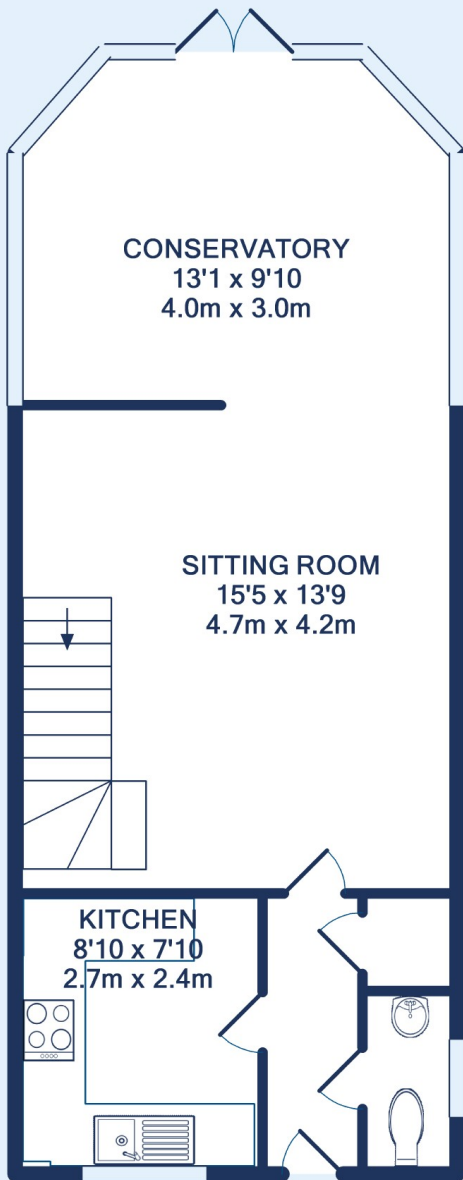

Accommodation

Sitting Room

Conservatory

Kitchen

Master Bedroom

Bedroom Two

Bedroom Three

Bathroom



Stoke Gifford - Guide price £265,000

3 Bed Terraced house

References to the Tenure of a Property are based on information supplied by the Seller. The Agent has not had sight of the title documents. Lease details, service ground rent (where applicable) are given as a guide only and should be checked and confirmed by your solicitor prior to exchange of contracts.



Bradley Stoke Branch

Ocean, Unit 7 The Willowbrook Centre, Bradley Stoke,

Call: 01454 205070

Mail: bradleystokesales@oceanhome.co.uk

Search: www.oceanhome.co.uk