



Fourwinds, 6 The Crest, Bledlow Ridge, Buckinghamshire, HP14 4AQ

Asking Price | £850,000

Property Features

- Well Maintained Detached Home
- 4 Good sized Bedrooms
- Beautiful Established Garden
- Modern Open Plan Kitchen/Dining Room
- Large Living Room with Stovax Log Burner
- Conservatory Looking on to the Rear Garden
- Driveway Parking and Garage
- Close to Open Countryside
- Close to Local Primary and Secondary Schools
- EPC 68 D / Council Tax Band F

Full Description

This stunning detached house for sale in Bledlow Ridge boasts ample living space, four spacious bedrooms and a wealth of charming features as well as a beautiful established rear garden.

The house was originally built in the 1950s for the managers of local company, Molins and offers impressive living accommodation. It is complete with conservatory and a large open plan kitchen/dining room, perfect for entertaining guests. The modern and spacious kitchen is fitted with John Lewis cupboards and has all the necessary appliances for a seamless cooking experience. The living room features a working Stovax log fireplace, making it the perfect place to relax after a long day. There is also a dining room and a convenient utility room.

The property features four good-sized bedrooms which allows for plenty of natural light, with the rear bedrooms overlooking the gorgeous garden.

Externally, the property offers a beautiful private garden, complete with a patio area perfect for al fresco dining, ideal for enjoying the summer months. There is a small vegetable patch and greenhouse and a variety of fruit trees and bushes. The garage offers ample parking and storage for vehicles and other items.

Bledlow Ridge is a charming village situated in the stunning Buckinghamshire countryside. With a thriving community, local shops and pubs, it is perfect for those who enjoy a relaxed English lifestyle. High Wycombe, located just a short drive away, offers a wider range of amenities including a shopping centre, cinemas, restaurants and bars, making it perfect for those who enjoy a night out or a day of shopping.

For outdoor enthusiasts, there are plenty of opportunities to explore the countryside, from peaceful walks to energetic hikes in the beautiful Chiltern Hills. There are also several parks and gardens in the area, such as Hughenden Manor and West Wycombe Park, which offer beautiful scenery and a glimpse into the area's rich history. The property is close to the village primary school and is conveniently located near to the bus stop for transport to the local secondary schools.





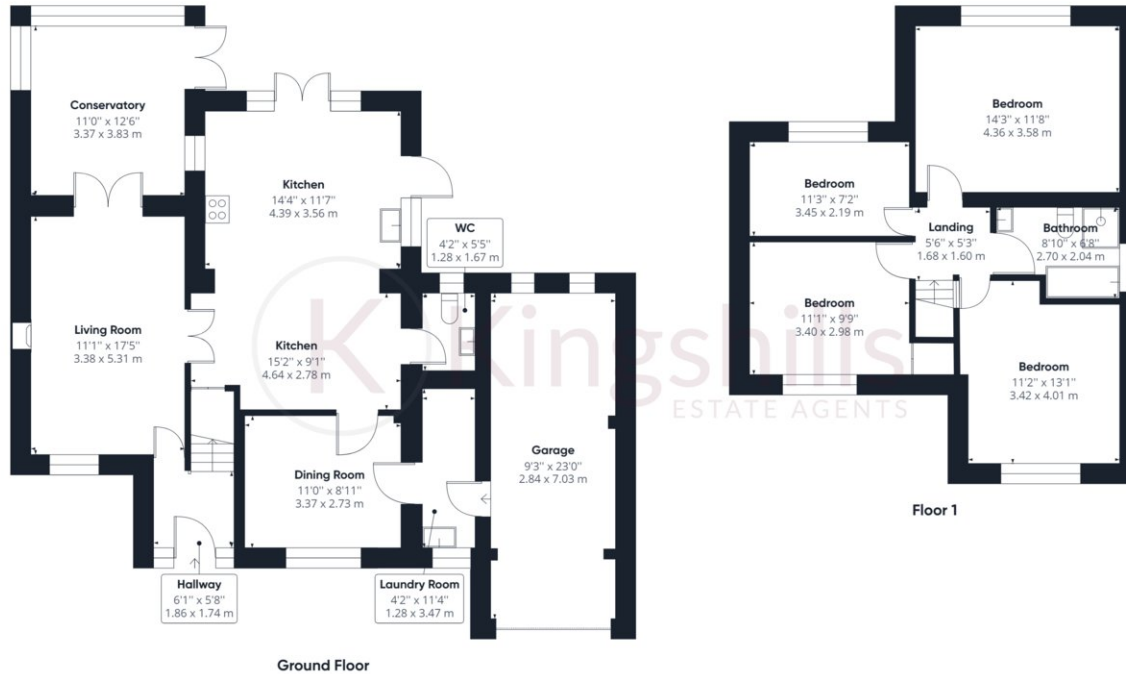

Approximate total area⁽¹⁾

1724.69 ft²

160.23 m²

(1) Excluding balconies and terraces

While every attempt has been made to ensure accuracy, all measurements are approximate, not to scale. This floor plan is for illustrative purposes only.

GIRAFFE360