



Courtfield Gardens SW5

Leasehold



Two double bedrooms, two bathrooms, a study and two private patios. This delightful combination of classic appeal and contemporary comfort is not to be missed. Situated within a period stucco building on the lower ground floor, this lovely apartment offers a great accommodation of over 1440 sqft. In addition, this spacious apartment benefits from a beautiful front living room with large bay windows, wooden floors and a fireplace. Large eat-in kitchen with direct access to the patio, separate utility room and high ceilings throughout the property. Located on the square, you will have access to the private gardens and easy access to all local transport and shopping facilities.

- Two double bedrooms
- Two Bathrooms
- Eat-in kitchen
- Study

- Large living room
- Separate utility room
- Large storage room
- High ceilings

- Great condition throughout
- Two private patios
- Over 920 years lease
- Access to private garden

- Beautiful stucco building
- Close to transport
- Close proximity to Kensington Gardens



Courtfield Gardens

Courtfield Gardens is a highly desirable location nestled within the prestigious borough of Kensington and Chelsea in London. This picturesque square is known for its elegance, tranquillity, and close proximity to various amenities.

The iconic Royal Albert Hall, and renowned museums such as the Victoria and Albert Museum, the Natural History Museum, and the Science Museum are just a short distance away.



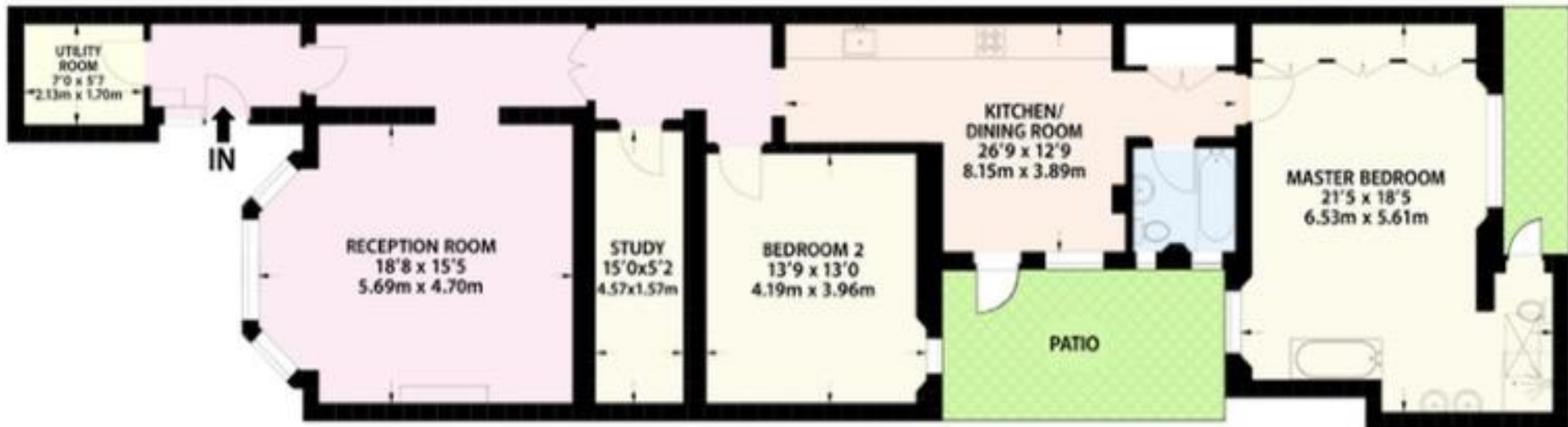

LOWER GROUND FLOOR
Approximate Gross Internal Area
1442 sq ft / 134.06 sq m

This plan has been drawn for illustrative and identification purposes only.

Energy Efficiency Rating		Current	Potentia
Very energy efficient - lower running costs			
(92-100)	A		
(81-91)	B		
(69-80)	C		75
(55-68)	D	55	
(39-54)	E		
(21-38)	F		
(1-20)	G		



PINEBROOK
ESTATES

Viewings strictly by appointment.
Please contact our agent Bozena Dela

4th Floor Silverstream House,
45 Fitzroy Street, Fitzrovia
London W1T 6EB

M: + 44 (0) 7863172705
T: + 44 (0) 203 835 5645

 info@pinebrookestates.co.uk

 www.pinebrookestates.co.uk

