



The Nest, Speen Road, North Dean, High Wycombe, Buckinghamshire, HP14 4NL

Asking Price | £1,100

Property Features

- Beautiful Grade II Listed Brick and Flint Cottage
- Suits a Single Occupant
- Nestled in the Chiltern Hills
- Amazing Views to the Front of the Property
- Open Plan Living/Dining/Kitchen
- Kitchen with Fitted Appliances
- Bedroom and Bathroom
- Gardens to The Side and Brick Built Store
- Parking to The Front
- Pets Considered

Full Description

Nestled in the heart of the Chiltern Hills and surrounded by Beech woodland in a quiet and peaceful hamlet, this beautiful Grade II listed cottage offers a charming retreat from the hustle and bustle of city life, boasting breathtaking scenery and abundant opportunities for outdoor recreation. This cosy property features a bright and open-plan lounge, well-equipped kitchen with petite dining area and first floor bedroom and spacious shower room. The loft is fully boarded and fitted with ladder to provide easily accessible additional storage.

Outside you will find a low-maintenance part-paved courtyard garden that offers great entertaining in those summer nights. To the rear is a separate brick-built store, providing further domestic appliances and storage. To the front is an off-road parking space for one car.

From the front door are countless footpaths and bridleways, ranging from gentle strolls to challenging hikes that offer breathtaking views of the surrounding landscape.

Transport links are excellent, with major roads and motorways easily accessible from the property. Connections from the market town of Princes Risborough or the larger town of High Wycombe are both within 5 miles, both providing rapid train services to London Marylebone.





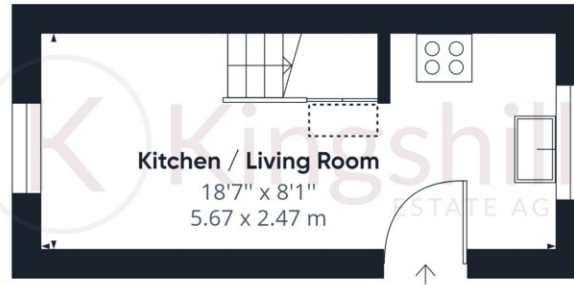

Ground Floor

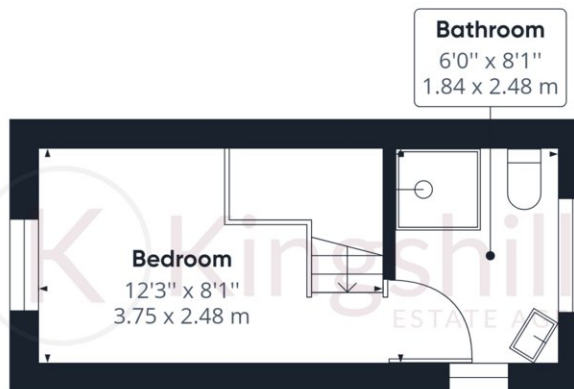

Floor 1

Approximate total area⁽¹⁾

283.13 ft²
26.30 m²

Reduced headroom

2.88 ft²
0.27 m²

(1) Excluding balconies and terraces

☒ Reduced headroom
(below 1.5m/4.92ft)

While every attempt has been made to ensure accuracy, all measurements are approximate, not to scale. This floor plan is for illustrative purposes only.

GIRAFFE360