

Property Features

- 3 Bedroom Semi Detached
- Complete Refurbishment Required
- Living Room/Dining Room
- Kitchen
- Bathroom
- Driveway Parking
- Rear Gardens
- Please see the virtual tour prior to booking in a viewing
- EPC G 1 / Council Tax Band C

Full Description

Are you searching for your next renovation project? Look no further! This semi-detached house in High Wycombe offers a fantastic opportunity for those with a vision to transform a property. With three bedrooms, driveway parking and private rear garden, this blank canvas is brimming with potential.

Upon entering the property, you'll immediately notice the untapped potential and spacious layout. The interior requires a complete renovation, allowing you to customize every aspect to your liking.

The house features a living room/diner, kitchen, bathroom and three bedrooms, each with its unique character and potential. This property offers the canvas on which to build your vision.

The garden, though in need of attention, is a generous space that can be transformed into a beautiful outdoor oasis. Whether you dream of lush greenery, a serene patio, or a vibrant vegetable garden, this space is yours to craft.

The convenience of a driveway provides off-road parking for your vehicles, a valuable feature in this area.

Location:

Situated in High Wycombe, you'll have access to a wide range of amenities, including schools, shops, and transport links. High Wycombe offers excellent commuter options, with the train station connecting you to London Marylebone in under 30 minutes. The nearby M40 motorway ensures easy access to other major cities.

In Summary:

This semi-detached house in High Wycombe represents an exciting project for those with a passion for renovation. With 3 bedrooms, a driveway, and a garden, it provides the perfect canvas to create a truly unique and personalized home.





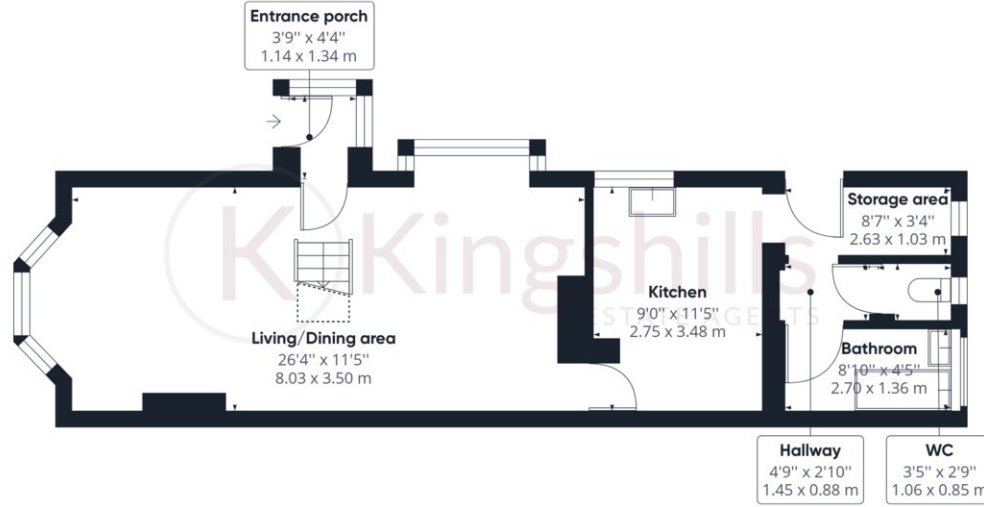

Ground Floor



Floor 1

Approximate total area⁽¹⁾

936.11 ft²
86.97 m²

Reduced headroom

10.53 ft²
0.98 m²

(1) Excluding balconies and terraces

 Reduced headroom
(below 1.5m/4.92ft)

While every attempt has been made to ensure accuracy, all measurements are approximate, not to scale. This floor plan is for illustrative purposes only.

GIRAFFE360