



1 Greenacres, Green Hill, High Wycombe, Buckinghamshire, HP13 5QB

Guide Price | £400,000

Property Features

- Three Bedroom Semi Detached Home
- Close to Green Hill Woods and Hughenden Park
- Cloakroom and Conservatory
- Gas Central Heating and Double Glazing
- Allocated Parking
- Enclosed Gardens
- Modern kitchen
- Elevated position with great views
- Short distance To Town Centre & Train Station
- Awaiting EPC / Council Tax Band D

Full Description

A three bedroom semi detached house located close to the town centre, Hughenden Park and the Royal Grammar School.

The house is deceptively spacious, well presented and is ideal for anyone wanting access to lovely woodland walks as well as popular schooling.

On the ground floor there is a spacious lounge/diner leading to a conservatory, modern kitchen and cloakroom. On the first floor there are three bedrooms and a shower room.

To the rear, there is a patio area with steps leading to an area of lawn and allocated parking.

High Wycombe town centre offers the bustling Eden shopping centre, a new leisure centre along with a huge range of busy restaurants and bars, the town is fast becoming the place to live for everyone from first time buyers to seasoned commuters alike. Placed at Junction 4 of the M40 and having a train station in the centre offering a short commute to London Marylebone, High Wycombe is an ideal location to commute from. With a range of fantastic primary as well as renowned grammar and private schools, education is one of the main reasons people move to High Wycombe and stay there.





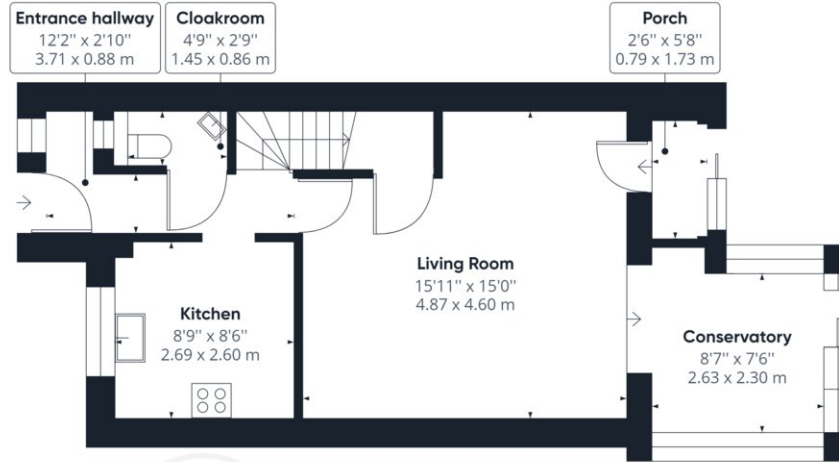

Ground Floor

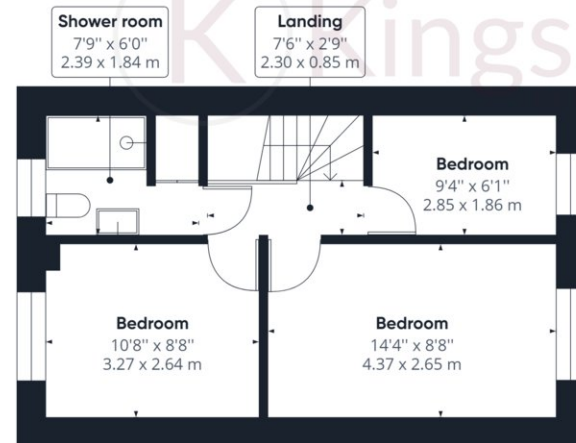

Floor 1



Approximate total area⁽¹⁾

829.10 ft²

77.03 m²

(1) Excluding balconies and terraces

While every attempt has been made to ensure accuracy, all measurements are approximate, not to scale. This floor plan is for illustrative purposes only.

GIRAFFE360

Kingshills Estate Agents
Comet Studios
Amersham
Buckinghamshire
HP7 0PX

01494 939868
hello@kingshills.co.uk
kingshills.co.uk

Agents Note: Whilst every care has been taken to prepare these particulars, they are for guidance purposes only. All measurements are for general guidance purposes only and whilst every care has been taken to ensure accuracy, they should not be relied upon and potential buyers/tenants are advised to recheck the measurements