

Moving You



Swaish Drive, Barrs Court, Bristol

07507 189300

Asking Price £340,000

guy.rolfe@moving-you.co.uk

Freehold

www.moving-you.co.uk









Swais Drive, Bristol, BS30 7AB

Welcome to this charming semi-detached family home! It's up for sale and waiting for a lovely family or couple to make it their own. The property is neutrally decorated, providing a blank canvas for you to add your own personal touch and style.

As you enter this lovely home, you'll find a handy downstairs W.C for convenience.

Step inside further and you'll find a cosy front reception room for you to unwind in after a long day. The house boasts a modern open-plan kitchen overlooking the rear garden, recently refurbished and fitted with modern appliances, ready for you to cook up a storm.

The property offers comfortable living with three bedrooms. The master bedroom is a generous space, designed to offer a calm and peaceful environment for restful nights. The second bedroom is a double, filled with natural light that creates a bright and airy feel. The third bedroom is a single, ideally suited for a child or as a guest room.

The bathroom, modern and refitted, adds a sense of sophistication and style. The unique feature of this property is the converted garage which is partly a utility/store and partly a home office perfect for hybrid workers. T

Located in a friendly neighbourhood, you'll find local schools, amenities, and green spaces close by. This strong local community is perfect for families and couples alike, offering a warm welcome to its new residents. Make this home yours and start making unforgettable memories.

Council Tax Band C







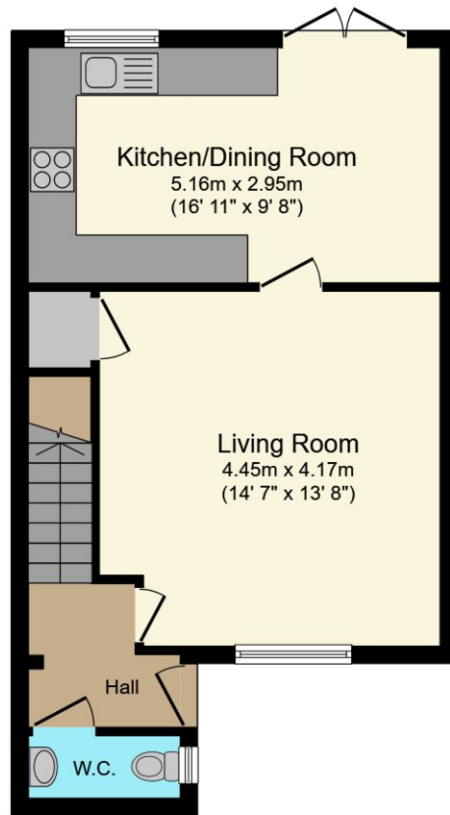

Ground Floor
Floor area 42.3 m² (455 sq.ft.)

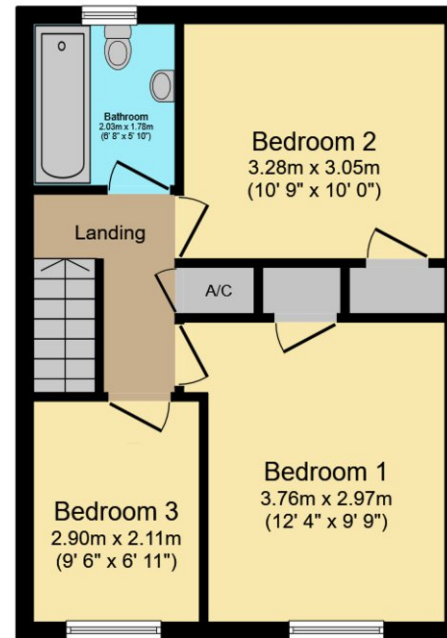

First Floor
Floor area 38.6 m² (416 sq.ft.)

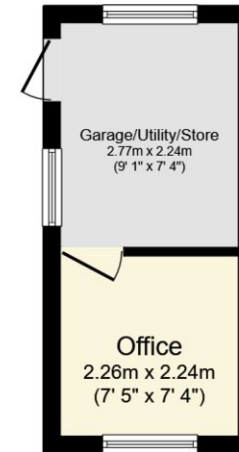

Outbuilding
Floor area 11.6 m²
(125 sq.ft.)

TOTAL: 92.4 m² (995 sq.ft.)

This floor plan is for illustrative purposes only. It is not drawn to scale. Any measurements, floor areas (including any total floor area), openings and orientations are approximate. No details are guaranteed, they cannot be relied upon for any purpose and do not form any part of any agreement. No liability is taken for any error, omission or misstatement. A party must rely upon its own inspection(s). Powered by www.Propertybox.io

Guy Rolfe Moving You

07507 189300

guy.rolfe@moving-you.co.uk

PROPERTY MISDESCRIPTIONS ACT 1991: The Agents has not tested any apparatus, equipment, fixtures and fittings, or services, so cannot verify that they are in working order or fit for the purpose. The buyer is advised to obtain verification from his or her Professional Buyer, References to the Tenure of the property are based on information supplied by the Vendor. The agents have not had sight of the title documents. The buyer is advised to obtain verification from their Solicitor. You are advised to check the availability of any property before travelling any distance to view.

www.moving-you.co.uk