



4 Tamar Close, High Wycombe, Buckinghamshire, HP13 7BG

Asking Price | £445,000

Property Features

- Three Bedroom Semi-Detached House
- No Upper Chain
- Modern Kitchen with a Range of Appliances
- Newly Fitted Bathroom
- Low Maintenance Rear Garden
- Garage
- Driveway Parking
- Peaceful Location
- Within Walking Distance to Wycombe Heights Golf Club
- EPC 71C / Council Tax Band D

Full Description

A fantastic and modern three-bedroom semi-detached house located in Tamar Close. The house features a spacious living area that is ideal for entertaining guests or relaxing, a refurbished kitchen that is fully equipped with modern appliances, making it perfect for both casual and formal dining and a newly fitted bathroom. The house offers two large double bedrooms and a further single bedroom.

The low maintenance rear garden is perfect for spending time outdoors and includes a lovely seating area, making it ideal for relaxing and enjoying the beautiful surroundings. The property also benefits from a garage driveway parking.

The location of the house is ideal for those who work in or around High Wycombe or London. The house is situated in a peaceful area, which is perfect for those who prefer a quiet and private neighbourhood. The property is within easy reach of various transportation services, making it easy for locals to travel around surrounding areas. The property is also located close to popular local amenities such as supermarkets, restaurants, and various leisure activities such as sports centres and cinemas.

High Wycombe is a charming town within Buckinghamshire and offers a wide range of activities and attractions. There are various parks and hiking trails, making it ideal for those who enjoy walking, cycling and getting out into nature. High Wycombe has many excellent shopping and dining options, with the Eden Shopping Centre and the High Wycombe Market providing a range of shops and many traditional pubs and restaurants offering delicious food and drink.

Overall, this property in Tamar Close is a wonderful option for those looking for a comfortable and modern living space in a desirable location. High Wycombe is an ideal location for those who love the countryside, with various amenities and attractions within easy reach.





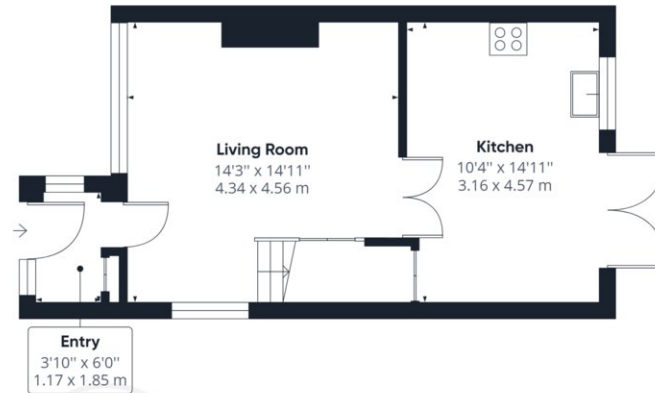

Ground Floor

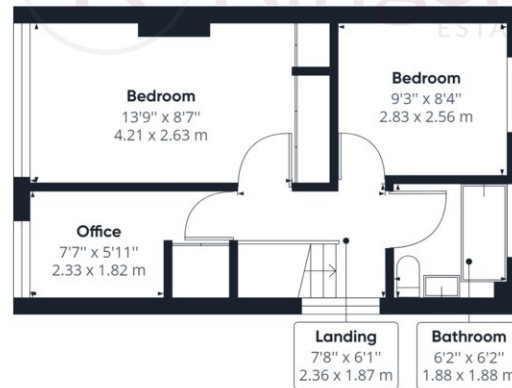

Floor 1

Approximate total area⁽¹⁾

742.91 ft²

69.02 m²

(1) Excluding balconies and terraces

While every attempt has been made to ensure accuracy, all measurements are approximate, not to scale. This floor plan is for illustrative purposes only.

GIRAFFE360