



**Avonmouth - £130,000**

1 bed flat

Imperial Chambers, BS11 9AQ



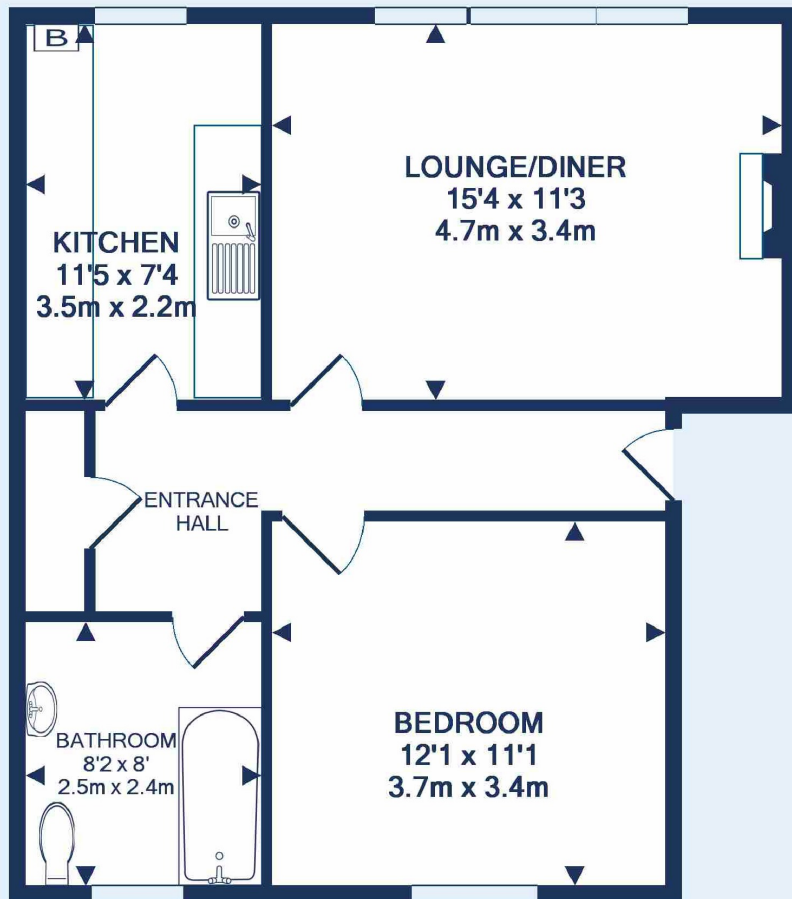

Made with Metropix ©2019



An attractive and spacious one bedroom 2nd floor apartment in a central Avonmouth village location.

The property is located on the corner of Gloucester Road and Avonmouth Road offering convenience for the railway station 150 metres away, 300 metres to the shops and the bus routes, schools and motorway networks are all nearby.

The accommodation consists entrance hall, lounge/diner, separate kitchen, double bedroom and bathroom.

Lending may be restricted due to commercial premises beneath so this may need checking prior to viewing.



### Shirehampton Office

14-16 High Street, Shirehampton, Bristol,  
BS11 0DP

Call: 0117 9380611

Mail:

Search: [oceanhome.co.uk](http://oceanhome.co.uk)

References to the Tenure of a Property are based on information supplied by the Seller. The Agent has not had sight of the title documents. Lease details, service ground rent (where applicable) are given as a guide only and should be checked and confirmed by your solicitor prior to exchange of contracts.