



Sovereign Court, Totteridge Avenue, High Wycombe, Buckinghamshire, HP13 6XL

Asking Price | £900

Property Description

A second floor one bedroom apartment within walking distance of High Wycombe town centre and train station. The accommodation comprises entrance; kitchen; living area; one bedrooms and bathroom. Available now on an unfurnished basis.

COUNCIL TAX C

EPC RATING D

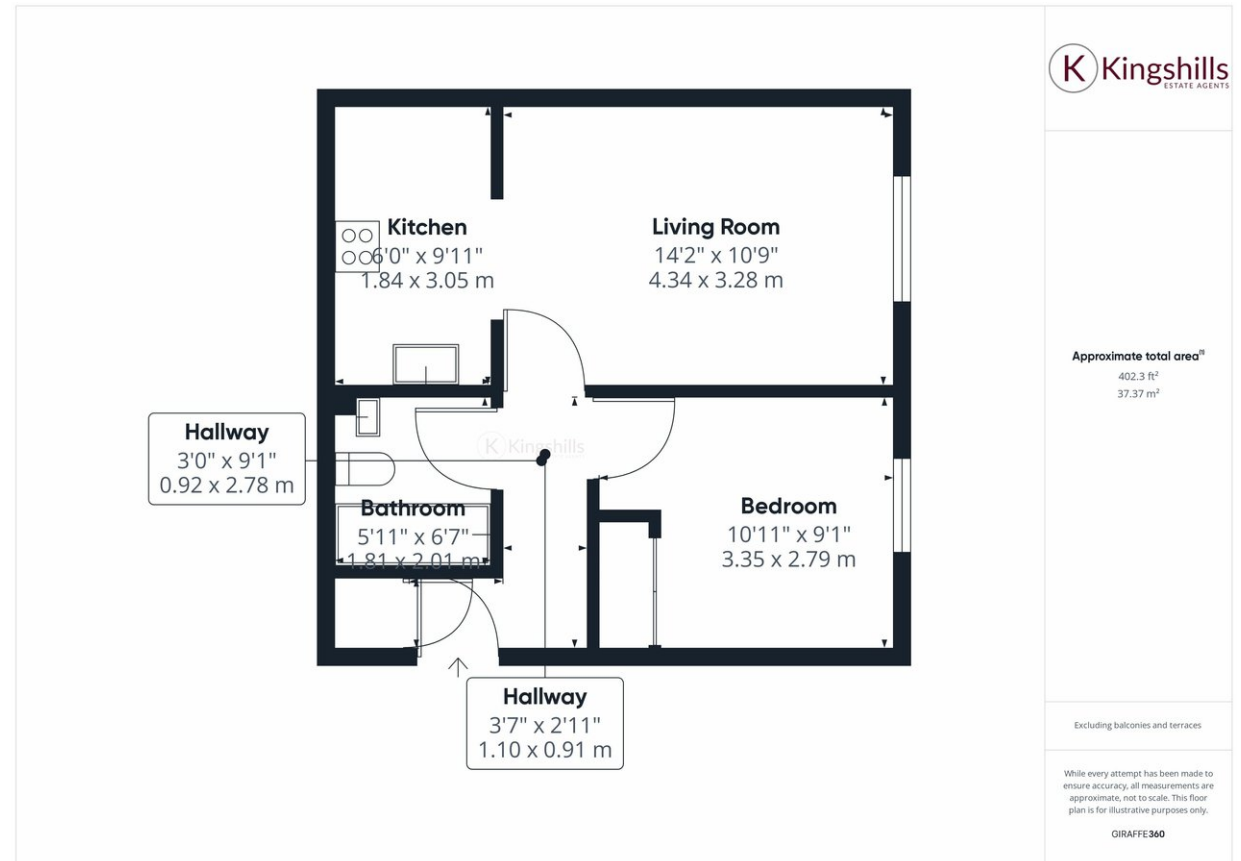

Kingshills Estate Agents
Comet Studios
Amersham
Buckinghamshire
HP7 0PX

01494 939868
hello@kingshills.co.uk
kingshills.co.uk

Agents Note: Whilst every care has been taken to prepare these particulars, they are for guidance purposes only. All measurements are for general guidance purposes only and whilst every care has been taken to ensure accuracy, they should not be relied upon and potential buyers/tenants are advised to recheck the measurements