

# HOME

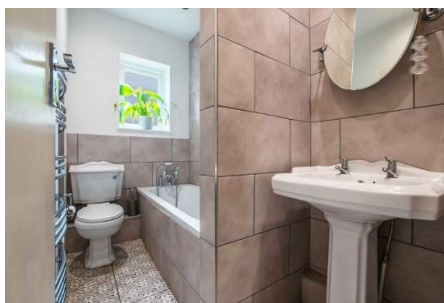

**Chelmsford**  
**Offers Over £280,000**  
**2-bed semi detached bungalow**

## Bruce Grove

Situated in an established residential location, approximately 1.5 miles from the city centre is this two bedroom semi-detached bungalow.

The accommodation comprises a kitchen, which is fitted with a range of base and eye level units and incorporates an integrated cooker and hob as well as having an entrance door.

The accommodation is flexible, as the present the current owners have a bedroom at the front of the house accessed from the kitchen, which has double glazed bay window. There is an inner hallway with doors leading to the bathroom and second bedroom. As well as giving access to a sitting room at the rear of the property, which alternatively could be used as the main bedroom.

The rear garden offers a decked and paved patio area, while then being laid principally to lawn with a large storage shed.

**Chelmsford**  
**11 Duke Street**  
**Essex CM1 1HL**

**Sales**  
01245 250 222  
**Lettings**  
01245 253 377  
**Mortgages**  
01245 253 370

[thehomepartnership.co.uk](http://thehomepartnership.co.uk)

Ground Floor

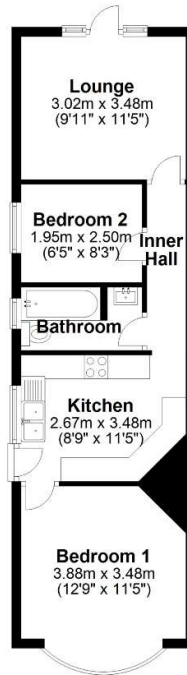

APPROX INTERNAL FLOOR AREA  
45 SQ M 480 SQ FT  
This plan is for layout guidance only and is NOT TO SCALE  
Whilst every care is taken in the preparation of this plan, please check all dimensions, shapes & compass bearings before making any decisions reliant upon them.



Features

- Two bedrooms
- Walking distance of Tesco's superstore
- Good access to the A414 & A12
- Various nearby schools
- Gas radiator central heating
- Scope to extend (STPP)
- Established residential location
- On street parking
- Approx. 1.5 miles from the City centre
- Ideal first time purchase

EPC Rating

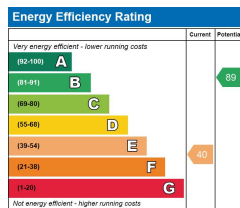

The Nitty Gritty

Tenure: Freehold

The Council tax band for the property is Band C with an annual amount of £1,768.32

As an integral part of the community, we've gotten to know the best professionals for the job. If we recommend one to you, it will be in good faith that they'll make the process as smooth as can be. Please be aware that a small number of the parties we recommend (certainly not the majority) may on occasion pay us a referral fee up to £200. You are under no obligation to use a third party we have recommended.

