



2nd Floor, Birch House, The Old Works, Leigh Street, High Wycombe, HP11 2WP

50% Shared Ownership | £149,999.50

Property Features

- Two Bedroom Apartment with En Suite
- 50% Shared Ownership
- Converted Historic Victorian Building
- Prime Central Location
- Light & Bright Apartment with High Ceilings and Tall Windows
- Contemporary Kitchen with Integrated Appliances
- Modern Shower Room & En-suite to Principal Bedroom
- Walking Distance to the Train Station
- Underground Allocated Parking
- Awaiting EPC / Awaiting Council Tax Band

Full Description

This light filled two bedroom 50% shared ownership apartment is located within Birch House of The Old Works development and has the added benefit of an en-suite to the principal bedroom as well as an open plan kitchen/diner/lounge. Nestled in the heart of High Wycombe, The Old Works is a celebration of the town's rich heritage and its promising future. This exceptional boutique style development has breathed new life into a splendid Victorian building, originally dedicated to the craft of chair making – a practice that High Wycombe is historically famous for.

As you enter this two bedroom apartment, you'll find yourself in a welcoming entrance space which sets the tone for the rest of the residence. Leading off the hallway is the second bedroom with a large industrial style window. Also branching off the entrance corridor, is a fully tiled shower room that features a pristine white suite, exuding a sense of elegance and cleanliness. In the hallway there is also a large double cupboard which allows you to neatly stow away items, ensuring a clutter-free environment that promotes relaxation and order.

The heart of this apartment is the open-plan living room and kitchen, thoughtfully designed to create a seamless and inviting space. The large industrial-style windows, high ceilings and wooden flooring create a bright and airy space. The kitchen in this open-plan studio features modern integrated appliances, sleek cabinetry and ample countertop space for meal preparation.

The cosy principal bedroom, offers a tranquil room to relax and unwind. There is a large warehouse style window which adds to the charm of this converted industrial apartment. For your added convenience, there is also a fully tiled en-suite complete with corner shower.

50% Shared Ownership Price £149,999.50 (full price £299,99)

Rent on The Remaining 50% Share £344 per month

Service Charge £1,280 per annum Lease: 250 years





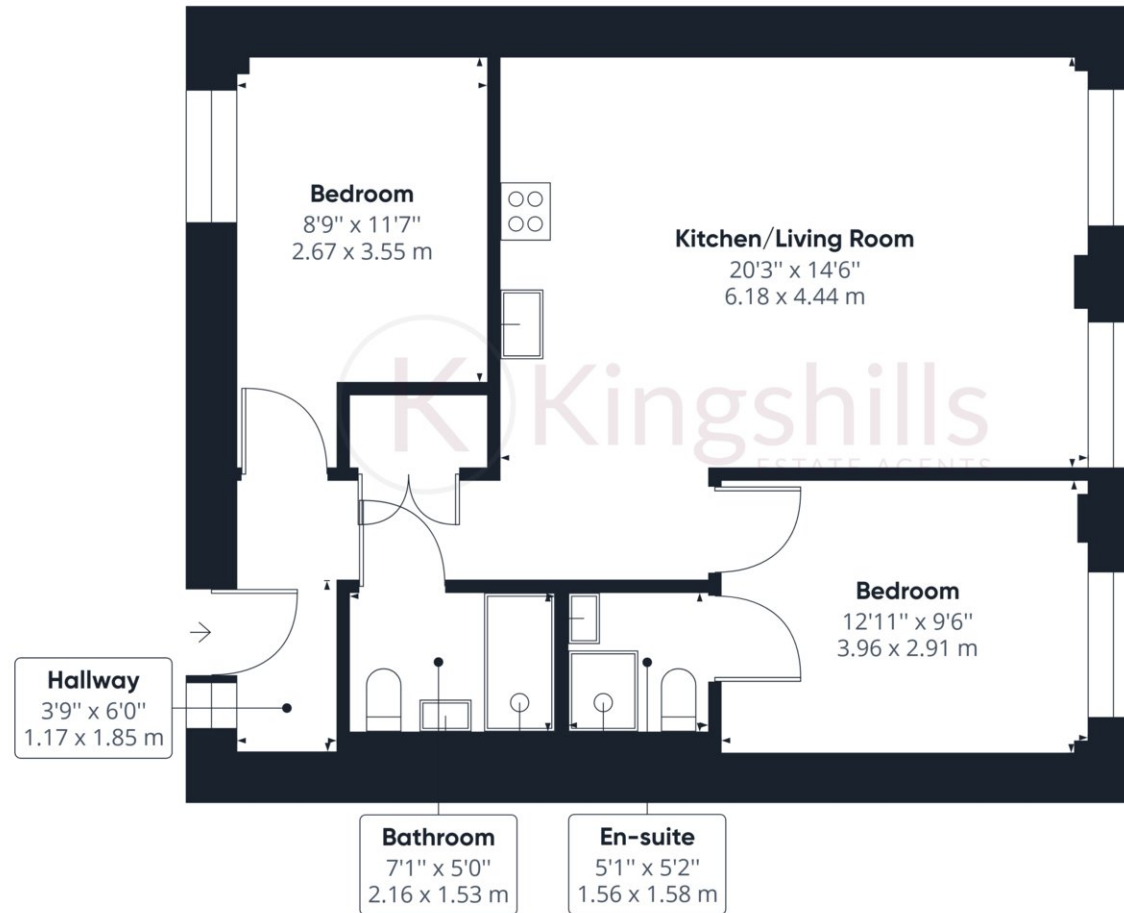

Approximate total area⁽¹⁾

724.98 ft²

67.35 m²

(1) Excluding balconies and terraces

While every attempt has been made to ensure accuracy, all measurements are approximate, not to scale. This floor plan is for illustrative purposes only.

GIRAFFE360